



4 Field Avenue Redcliffe WA

4 🏠 1 🚗 6 🚗

(EOI BY 9/9 - UNLESS SOLD PRIOR)

Set on huge 1004sqm corner block behind a classic white picket fence this Circa 1950's JWB & Iron character home steps into a new era, having been passed through the same family for 60 years. Lovingly cared for, renovated and extended over the years with five generations enjoying it's offerings. The original front end retains yesteryear charm and integrates with the massive extension, double garage, extensive alfresco and sparkling below-ground pool. The corner block is any man's dream with side drivethrough access to the rear, ample room for boats, vehicles, caravans and for those craving wide open space a massive backyard awaits. 25.12mt frontage to Field Ave plus seperate 40mt frontage to Epsom Avenue offers so many options for owners. Picturesque leafy frontage set among mature oak trees perfect for an old-fashioned tyre swing provide the ultimate for a traditional family lifestyle, but be

Price : FROM \$859,900
Building Size : 132 sqm
Land Size : 1004 sqm
View : <https://www.lauriekelly.com.au/sale/wa/eastern-suburbs/redcliffe/residential/house/8110825>



Devon Kelly
 08 9277 4200

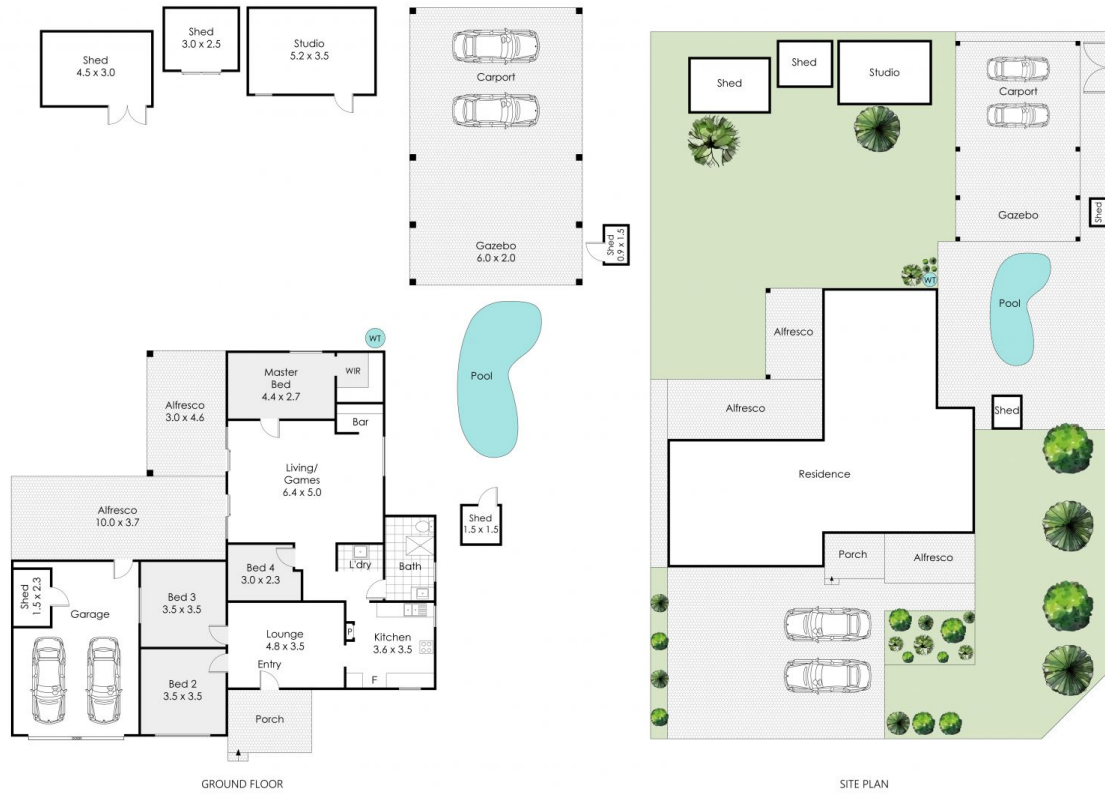

4 Field Avenue, Redcliffe

This floor plan is not to scale.
 Dimensions are approximate and therefore should only be used for illustrative purposes.

	1004 m ²
	4 Bed
	1 Bath
	6 Car