



4 Nottingham Street East Victoria Park WA

3 1 1

Built in 1951 this classic property is a rare testament to an era where quality prevailed over quantity. After 70 years the original owners are ready to part with this much treasured home.

Step back in time and appreciate this immaculate character home high on the hill. Situated on a sprawling 822sqm elevated block boasting an expansive 26mt frontage with endless design opportunities. Whether you are looking to nest, invest, renovate, extend or demolish this blue-ribbon slice of real estate beckons. Superbly located a short walking distance to lush parklands and a variety of well-established schools, desirable for growing families. The famous Vic Park Café strip close by offers a vibrant lifestyle. Owner's instructions are clear, this property after 70 years in the one family must be SOLD, so act swiftly and express your interest today.

Land Size : 822 sqm

View : <https://www.lauriekelly.com.au/sale/wa/south-hern-suburbs/east-victoria-park/residential/house/8083123>



Devon Kelly
08 9277 4200

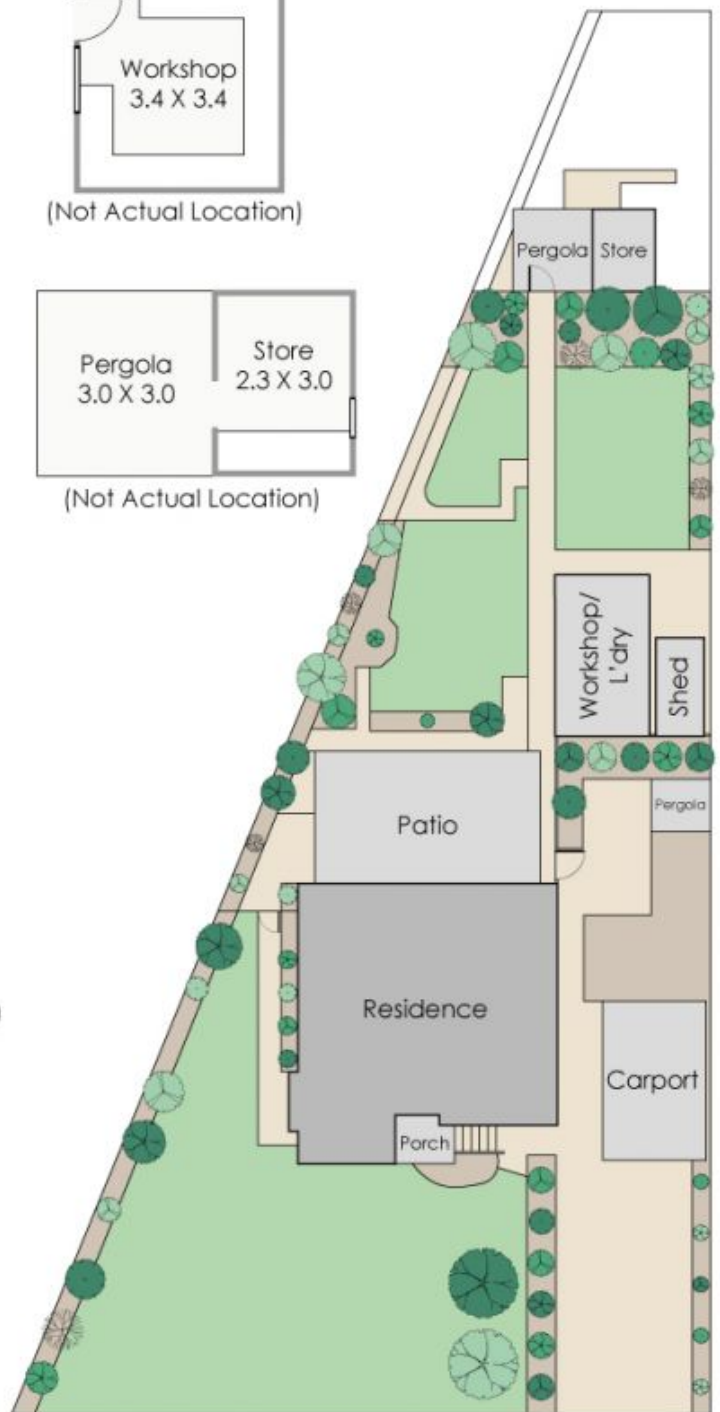
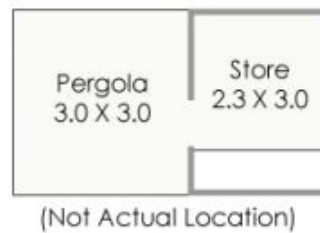

NOTTINGHAM STREET

Approximate Areas

Residence:	92m ²
Patio:	42m ²
Porch:	4m ²
Carport:	23m ²
Store:	7m ²
Workshop:	21m ²
Pergola:	13m ²

Total Area: 202m²

This floorplan is for illustration purposes only to show the layout of the property. Whilst every effort has been made to ensure the accuracy of this floor plan, all measurements, and any other information shown are an approximate interpretation only. Measurements and total areas do not include or account for wall thickness or roof area under eaves. Ciba Creative will not be held liable or responsible for any error, omission, misrepresentation or use of any information shown on the first floor plan. Not to be used for any other purpose.
www.cibacreative.com.au



4 Nottingham Street, East Victoria Park