



### 135B Thomas Street East Cannington WA

3 2 2

Style and sophistication, lifestyle and location, ticking all the boxes

Nestled in a quiet street next door to Maniana Park, you will find this stylish and sophisticated home boasting natural light, space, and low maintenance living.

The centre unit, amongst three, you are safe and secure, tucked away. This home has been cleverly designed to maximise space and livability for a downsizer, family or investment.

- Step inside, and you will be welcomed with a spacious tiled entry foyer that flows into the theatre room, perfect for those Saturday nights in; roll down the blinds, and it will be

[For full version visit the website](https://www.lauriekelly.com.au)

**Type** : House  
**Building Size** : 137 sqm  
**Land Size** : 268 sqm  
**View** : <https://www.lauriekelly.com.au/sale/wa/southern-suburbs/east-cannington/residential/house/8019586>



**Kim Findlay**  
08 9277 4200

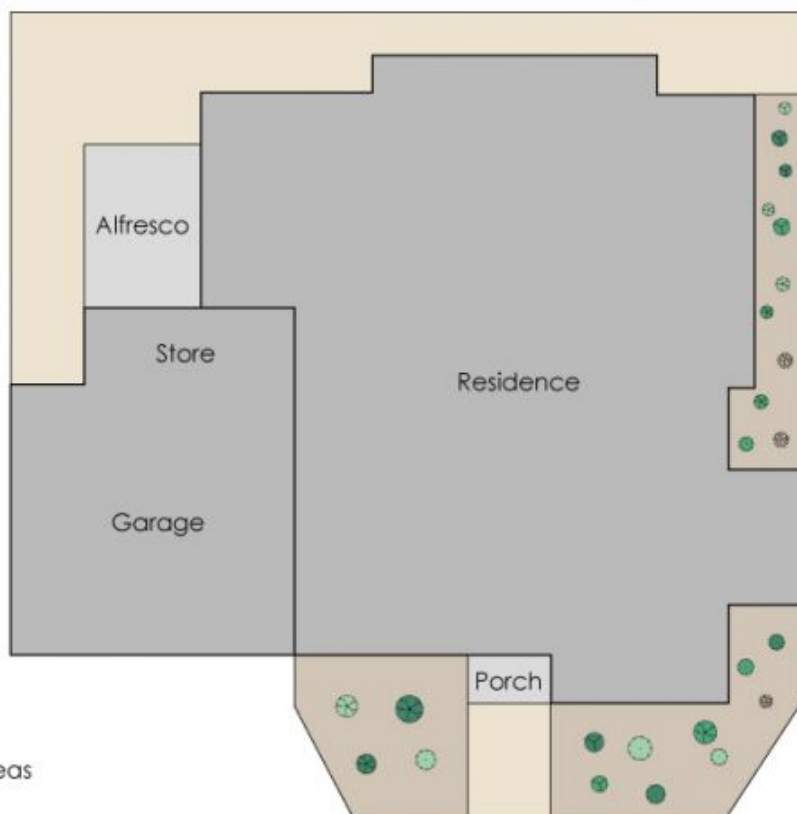
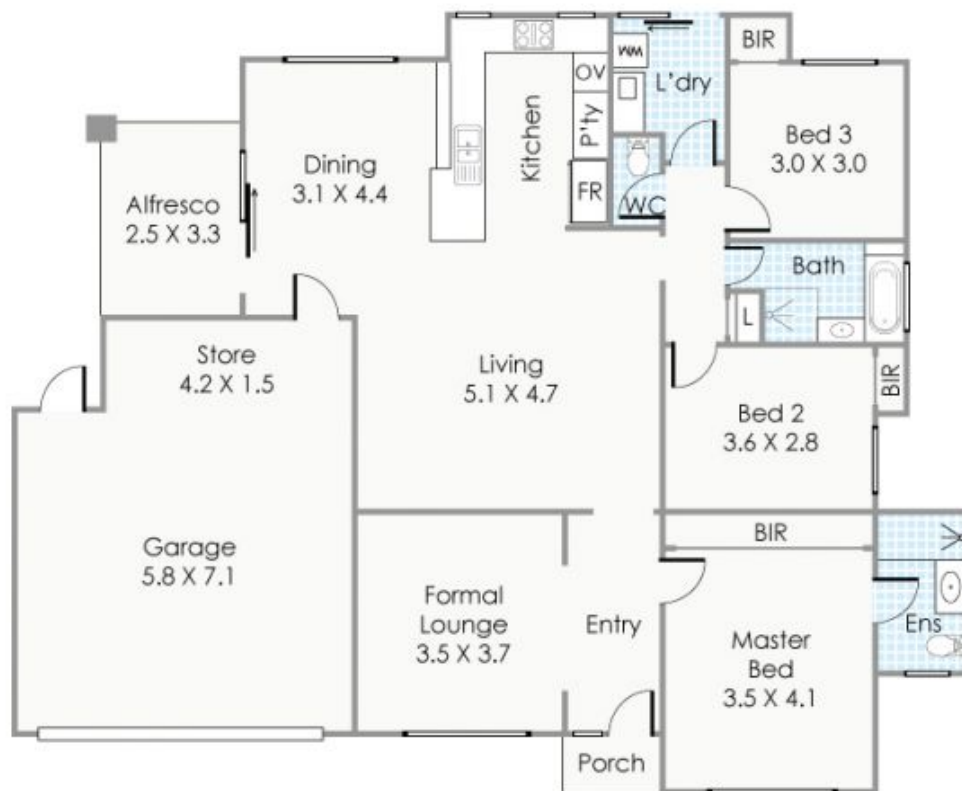

#### Approximate Areas

Residence:	137m <sup>2</sup>
Garage:	32m <sup>2</sup>
Alfresco:	8m <sup>2</sup>
Porch:	2m <sup>2</sup>
Store:	6m <sup>2</sup>
<b>Total Area:</b>	<b>185m<sup>2</sup></b>

This floorplan is for illustration purposes only to show the layout of the property. Whilst every effort has been made to ensure the accuracy of this floor plan, all measurements, and any other information shown are an approximate interpretation only. Measurements and total areas do not include or account for wall thickness or roof area under eaves. Crib Creative will not be held liable or responsible for any error, omission, misrepresentation or use of any information shown on the final floor plan. Not to be used for any other purpose.  
www.cribcreative.com.au



135B Thomas Street, East Cannington