

3/8 Hillcrest Road Kewdale WA

3 2 2

When size matters, this massive two storey townhouse in sought after Tomato Lake location is a no brainer! With full double brick/colour bond roof construction as well as boasting 159sqm of actual living area this property is poised to sell quickly. Fully refurbished this outstanding opportunity is perfect for the fussy first homebuyer, lock and leave FIFO worker or astute property investor wanting to get into a high return investment. When I say this property will not last, heed my warning and avoid total disappointment by contacting me today.

RED HOT FEATURES INCLUDE

? Federation red double brick/colour bond roof construction.

? Front entry porch opens into massive tiled living with split a/c.

Building Size : 192 sqm
Land Size : 227 sqm
View : <https://www.lauriekelly.com.au/sale/wa/southern-suburbs/kewdale/residential/house/8019583>



Devon Kelly
08 9277 4200



Daniel Kelly
08 9277 4200

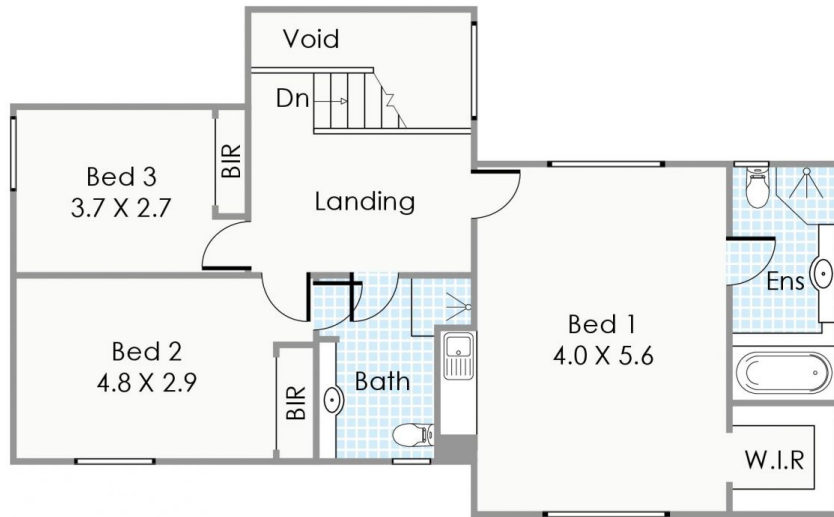

First Floor

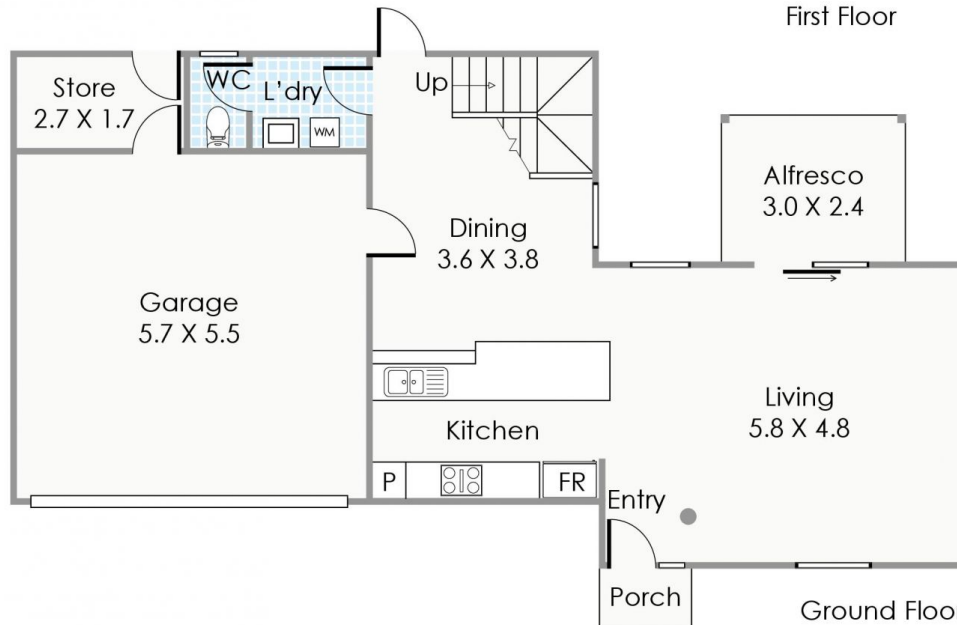

Ground Floor

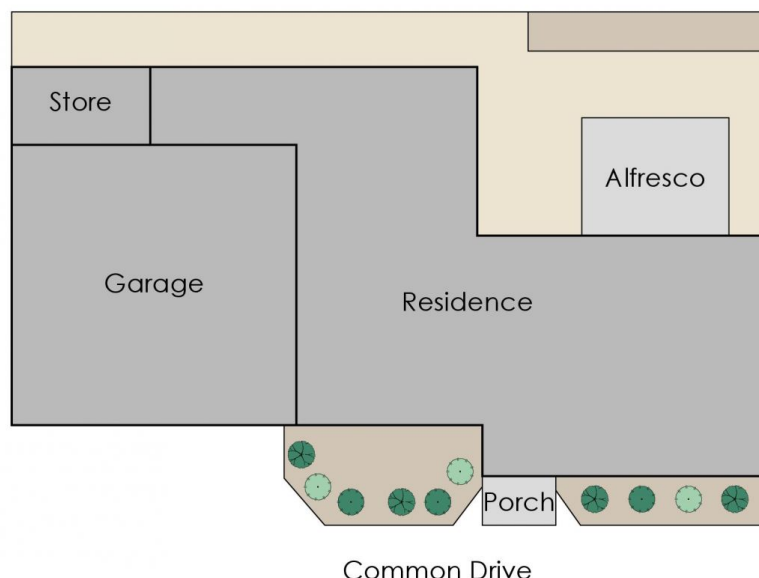

Approximate Areas

Ground Floor: 71m²
 First Floor: 85m²
 Store: 5m²
 Garage: 31m²
 Alfresco: 7m²

Total Area: 199m²
 Site Area: 227m²

This floorplan is for illustration purposes only to show the layout of the property. Whilst every effort has been made to ensure the accuracy of this floor plan, all measurements, and any other information shown are an approximate interpretation only. Measurements and total areas do not include or account for wall thickness or roof area under eaves. Crib Creative will not be held liable or responsible for any error, omission, misrepresentation or use of any information shown on the final floor plan. Not to be used for any other purpose.
www.cribcreative.com.au



3/8 Hillcrest Road, Kewdale

