



8/29 Orchid Street Joondanna WA

2 1 1

Designer apartment with city views

Nestled in the leafy Joondanna, a few minutes from Yokine Open Space, Terry Tyzack Aquatic, Dog Swamp shops and the jewel in the crown Mount Hawthorn cafe strip you will find the pristinely presented first-floor apartment, where luxe living and low maintenance meet.

In a secure boutique complex of just 8, featuring remote gate access and pedestrian gate with pin code entry, this apartment is surrounded by green lawns and flourishing gardens. Inside, you will be welcomed by that glorious open plan living, dining and kitchen area, fully tiled with high shadow lined ceilings, a reverse cycle split system to keep you cool in summer and snug in winter, extending out

[For full version visit the website](https://www.lauriekelly.com.au)

Type : Apartment
Building Size : 100 sqm
View : <https://www.lauriekelly.com.au/sale/wa/northern-suburbs/joondanna/residential/apartment/8019579>



Kim Findlay
08 9277 4200

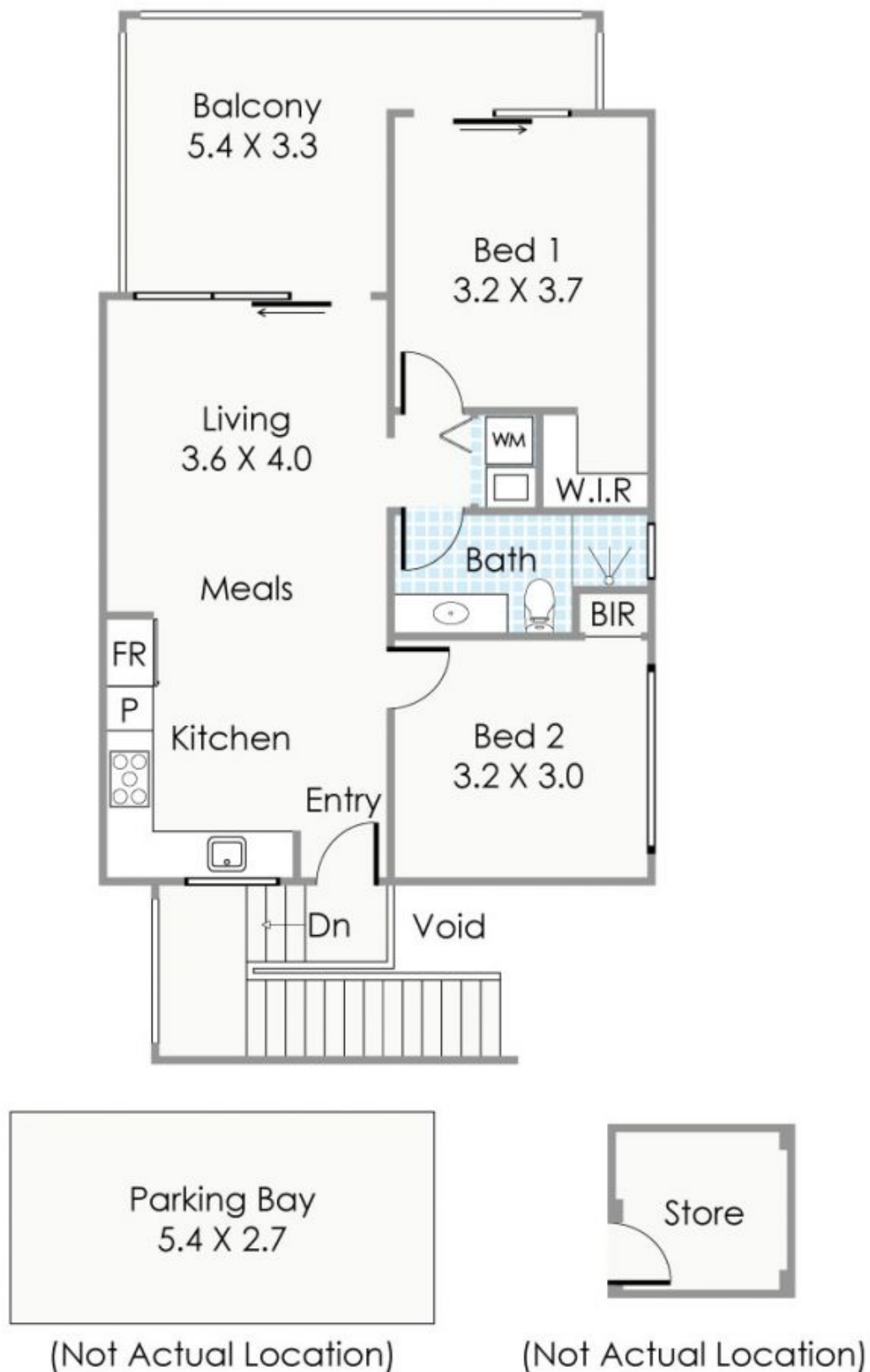

Approximate Areas

| | |
|--------------------|-------------------------|
| Residence: | 64m ² |
| Balcony: | 17m ² |
| Parking Bay: | 15m ² |
| Store: | 4m ² |
| Total Area: | 100m² |

This floorplan is for illustration purposes only to show the layout of the property. Whilst every effort has been made to ensure the accuracy of this floor plan, all measurements, and any other information shown are an approximate interpretation only. Measurements and total areas do not include or account for wall thickness or roof area under eaves. Ciba Creative will not be held liable or responsible for any error, omission, misrepresentation or use of any information shown on the final floor plan. Not to be used for any other purpose. www.cibacreative.com.au



8/29 Orchid Street, Joondanna