



228A St Kilda Road Kewdale WA

4 2 3

HOME OPEN SAT 16th 11:00-11:30AM

(VACANT POSSESSION AVAILABLE FROM THE 6/12/21)

Wow you will need to be very quick for this spacious 213sqm residence built in 2015 and situated in sought after Peet Park location on level 403sqm survey strata lot. The residence boasts a functional family layout with separate home theatre and a massive open kitchen / dining / family area tiled throughout. Ideally located only a short walking distance to Peet Park, Belmont Town Centre, schools and public transport you will be spoilt for lifestyle choices. Properties of this size and quality are tough to find so view with confidence and secure this well priced property today.

Type : House
Building Size : 214 sqm
Land Size : 403 sqm
View : <https://www.lauriekelly.com.au/sale/wa/southern-suburbs/kewdale/residential/house/8019569>



Devon Kelly
08 9277 4200



Daniel Kelly
08 9277 4200

[For full version visit the website](https://www.lauriekelly.com.au)

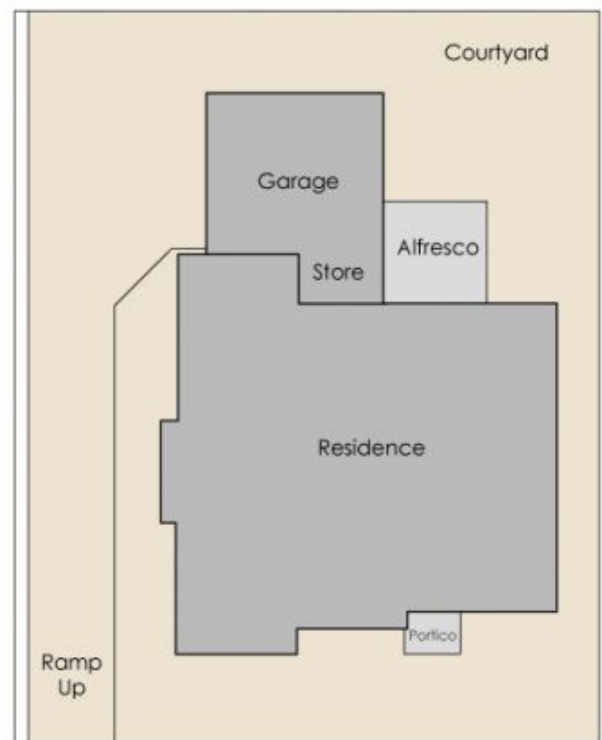

SAINT KILDA ROAD

Approximate Areas

Residence:	158m ²
Garage:	36m ²
Alfresco:	12m ²
Portico:	3m ²
Store:	5m ²

Total Area:	214m ²
Site Area:	457m ²

This floorplan is for illustration purposes only to show the layout of the property. Whilst every effort has been made to ensure the accuracy of this floor plan, all measurements, and any other information shown are an approximate interpretation only. Measurements and total areas do not include or account for wall thickness or roof area under eaves. Ciba Creative will not be held liable or responsible for any error, omission, misrepresentation or use of any information shown on the final floor plan. Not to be used for any other purpose.
www.cibacreative.com.au



228A Saint Kilda Road, Kewdale