



1/1 Rowe Avenue Rivervale WA

1 1 1

An apartment that feels more like a home with a HUGE 56sqm alfresco courtyard with direct access via your own pedestrian gate onto Riversdale Road.

Welcome to the pinnacle of resort style living at "Arbour North" - Apartment 1 @ 1 Rowe Avenue Rivervale. We have a super stylish 1brm apartment with 48sqm of living space, it is the ultimate lock and leave buying option!

Features at a glance:

- ? Constructed in 2015.
- ? Open plan kitchen/meals/living area with air-conditioning opening onto the huge alfresco courtyard.
- ? Kitchen with loads of cupboards incl pantry, stone benchtops, trendy glass splashbacks, dishwasher recess and stainless-steel cooking appliances.

Building Size : 48 sqm
View : <https://www.lauriekelly.com.au/sale/wa/eastern-suburbs/rivervale/residential/apartment/8012789>



Kim Findlay
08 9277 4200

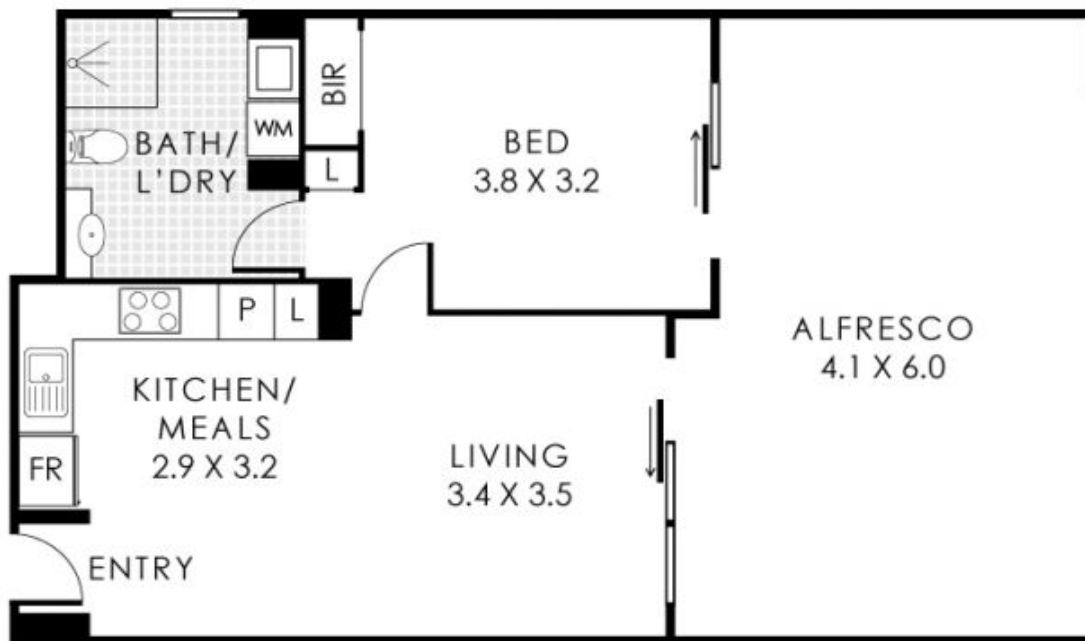

STORE
(NOT ACTUAL LOCATION)

CARBAY
(NOT ACTUAL LOCATION)



1/1 Rowe Avenue, Rivervale

Residence 48m² | Store 4m² | Carbay 14m² | Alfresco 56m²

Total Area 122m²



This floorplan is for illustration purposes only to show the layout of the property. Whilst every effort has been made to ensure the accuracy of the floor plan, all measurements and any other information shown are an approximate interpretation only. Measurements and total area do not include or account for wall thickness or roof area under eaves. C&P Creative will not be held liable or responsible for any error, omission, misrepresentation or use of any information shown on the floor plan. Not to be used for any other purposes.
www.cpcreative.com.au