



19A Ritchie Way Cloverdale WA

4 2 2

Nestled within idyllic tree-lined Ritchie Way is this modern 4 bedroom 2 bathroom green title home on 545sqm block, recently refreshed to an immaculate standard with no stone left unturned. Complete with double auto lockup garage plus additional pavement to park a caravan, boat or the like, central enclosed alfresco area surrounded by wraparound internal living/dining/kitchen floorplan, sunken home theatre and 4 large bedrooms, a comfortable lifestyle awaits.

Fine features include:

- secure lockable gated entrance to access the property
- private street positioning for a safe & secluded oasis
- double lockup automated garage repainted floors
- additional paved parking space to the home's frontage
- surrounding mature trees and foliage for natural shade
- easy-care low maintenance gardens and lawns

Building Size : 160 sqm
Land Size : 545 sqm
View : <https://www.lauriekelly.com.au/sale/wa/southern-suburbs/cloverdale/residential/house/8005287>



Devon Kelly
08 9277 4200

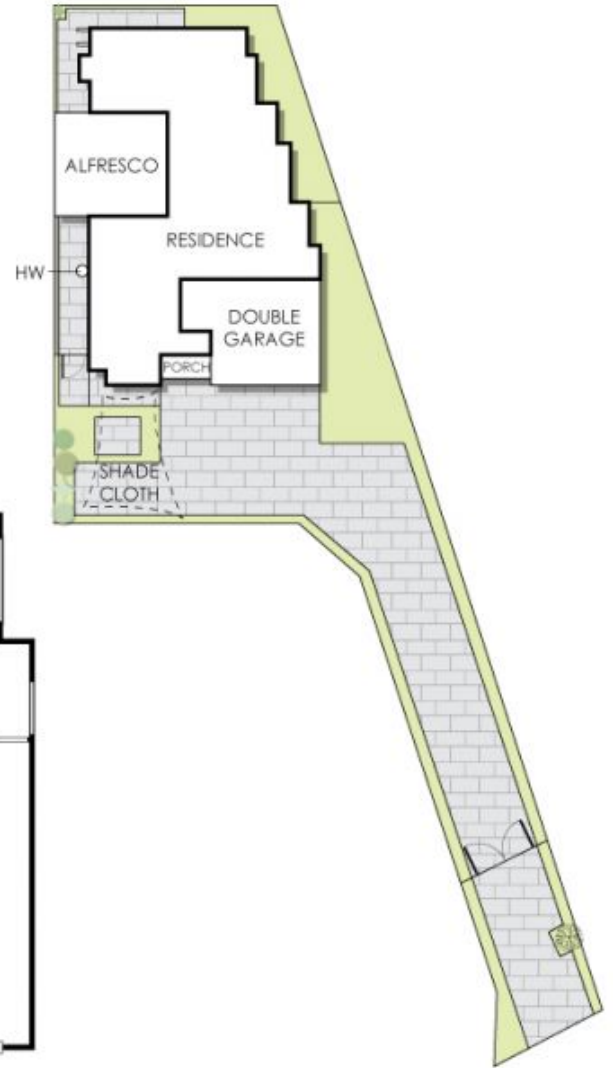

19A Ritchie Way, Cloverdale

Residence 160m² | Porch 3m² | Alfresco 31m² | Double Garage 33m² | Store 5m²

Total Area 232m²



This floorplan is for illustration purposes only to show the layout of the property. Whilst every effort has been made to ensure the accuracy of this floor plan, all measurements, and any other information shown are on approximate interpretation only. Measurements and total areas do not include or account for wall thickness or roof area under eaves. Ciba Creative will not be held liable or responsible for any errors, omissions, misrepresentation or use of any information shown on the final floor plan. Not to be used for any other purpose. www.cibacreative.com.au