



68 Kahana Parkway Butler WA

3 2 2

Coming soon is this modern 3 bedroom x 2 bathroom cute semi on cottage block opposite gorgeous parklands. With the existing tenant due to move out shortly you will need to move swiftly to avoid missing this one.

Features include:

- * Built in 2008
- * 3 bedroom (all with built in robes) x 2 bathrooms
- * Front verandah
- * Tiled entry foyer
- * Formal lounge room fully tiled with air-conditioner
- * Galley kitchen with freestanding breakfast bar with stainless steel cooking appliances and dishwasher.
- * Separate meals area fully tiled

[For full version visit the website](https://www.lauriekelly.com.au)

Type : Semi Detached
Building Size : 129 sqm
Land Size : 233 sqm
View : <https://www.lauriekelly.com.au/sale/wa/northern-suburbs/butler/residential/semi-detached/7936562>



Kim Findlay
08 9277 4200

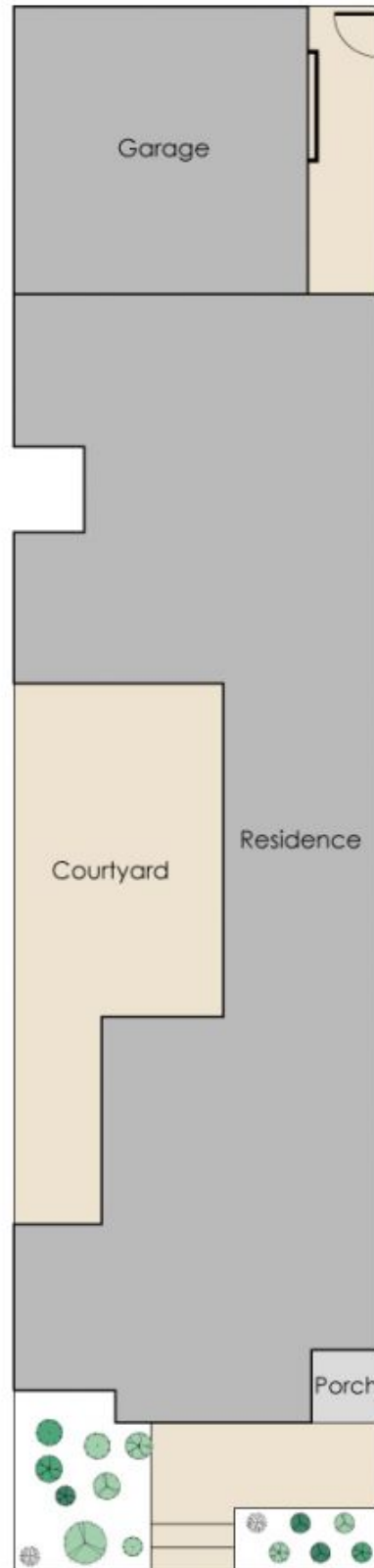
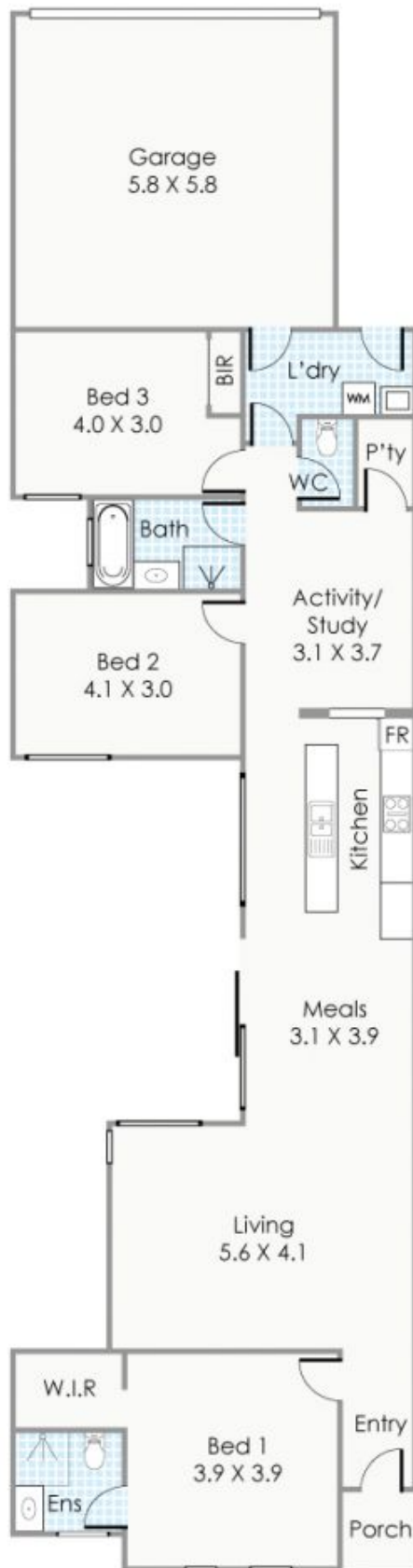

KAHANA PARKWAY

Approximate Areas

Residence:	129m ²
Garage:	34m ²
Porch:	2m ²
Total Area:	165m ²

This floorplan is for illustration purposes only to show the layout of the property. Whilst every effort has been made to ensure the accuracy of this floor plan, all measurements, and any other information shown are an approximate interpretation only. Measurements and total areas do not include or account for wall thickness or roof area under eaves. Ciba Creative will not be held liable or responsible for any error, omission, misrepresentation or use of any information shown on the final floor plan. Not to be used for any other purpose.
www.cibacreative.com.au



68 Kahana Parkway, Butler