



127 Fisher Street Belmont WA

4 🛏 1 🚗 2 🚗

RETAIN HOME - SUBDIVIDE - DEMOLISH

Extremely rare opportunity to secure an original one owner brick and tile character home set in highly sought-after Belmont location. Situated on a sprawling 1029sqm DUPLEX block with potential to retain the home and build at the rear (stca) the development options are endless. Built in 1967 the home has been extended and renovated over the years but requires a new owner to bring it back to its former glory. Perfect for the home renovator, small time developer or just a big block lover looking at space for the kids and their toys. Either way with the market booming you can't go wrong with an old-fashioned quarter acre so close to the Perth CBD

Type : House
Land Size : 1029 sqm
View : <https://www.lauriekelly.com.au/sale/wa/east-ern-suburbs/belmont/residential/house/7936553>



Devon Kelly
08 9277 4200



Daniel Kelly
08 9277 4200

[For full version visit the website](https://www.lauriekelly.com.au)

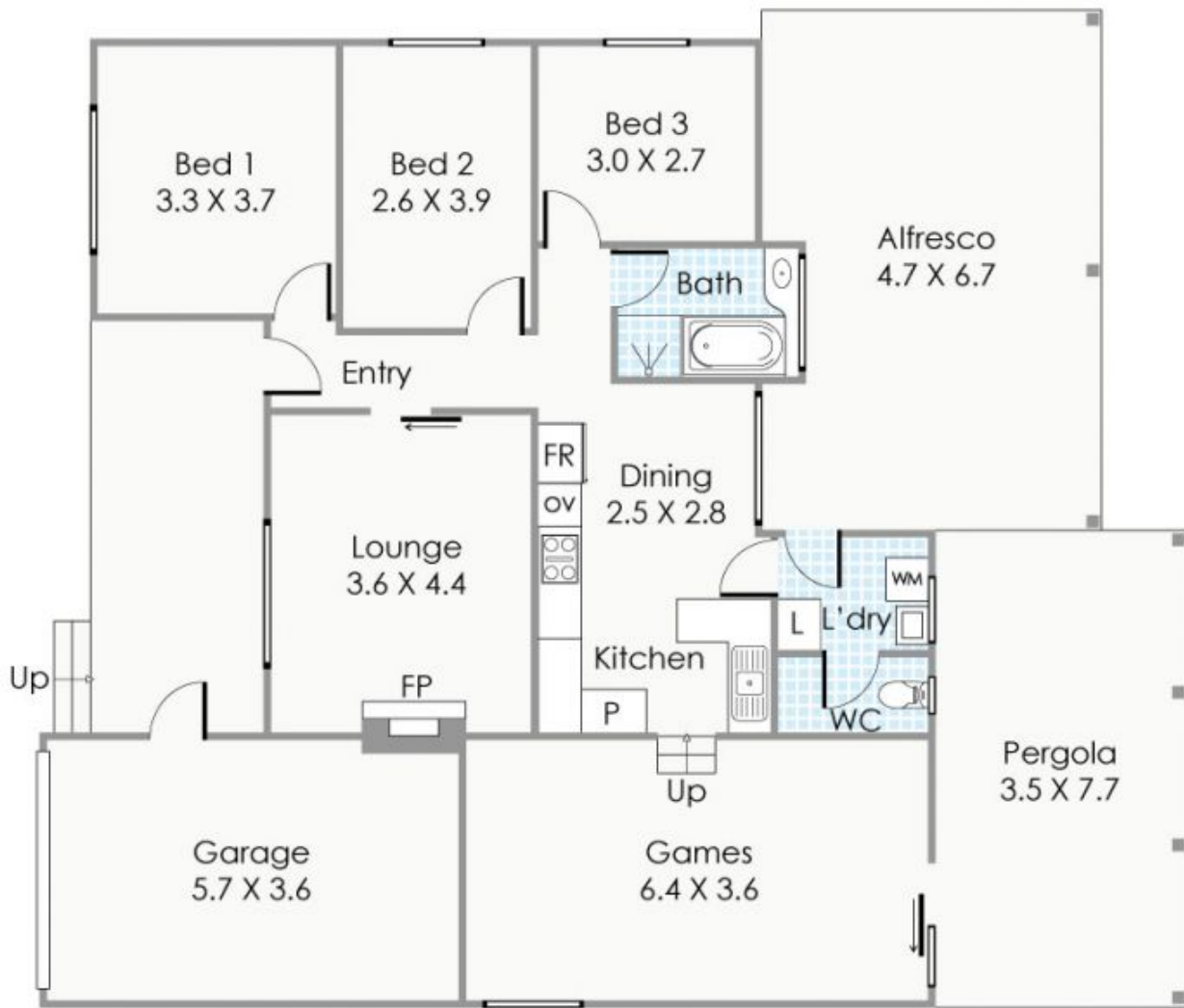

Approximate Areas

Residence:	104m ²
Garage:	21m ²
Pergola:	27m ²
Alfresco:	33m ²
Total Area:	185m²

This floorplan is for illustration purposes only to show the layout of the property. Whilst every effort has been made to ensure the accuracy of this floor plan, all measurements, and any other information shown are an approximate interpretation only. Measurements and total areas do not include or account for wall thickness or roof area under eaves. Crib Creative will not be held liable or responsible for any error, omission, misrepresentation or use of any information shown on the final floor plan. Not to be used for any other purpose. www.cribcreative.com.au



127 Fisher Street, Belmont

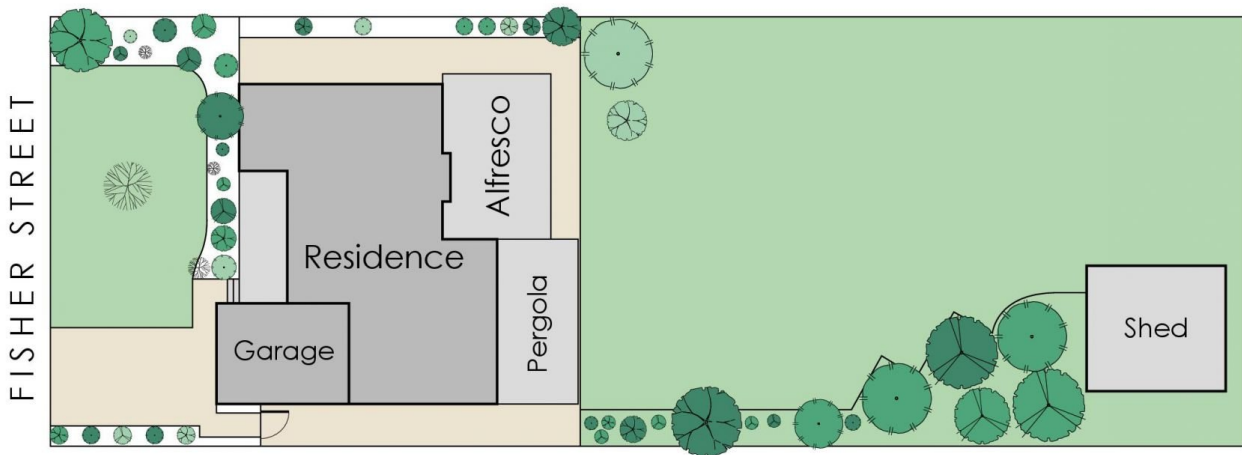
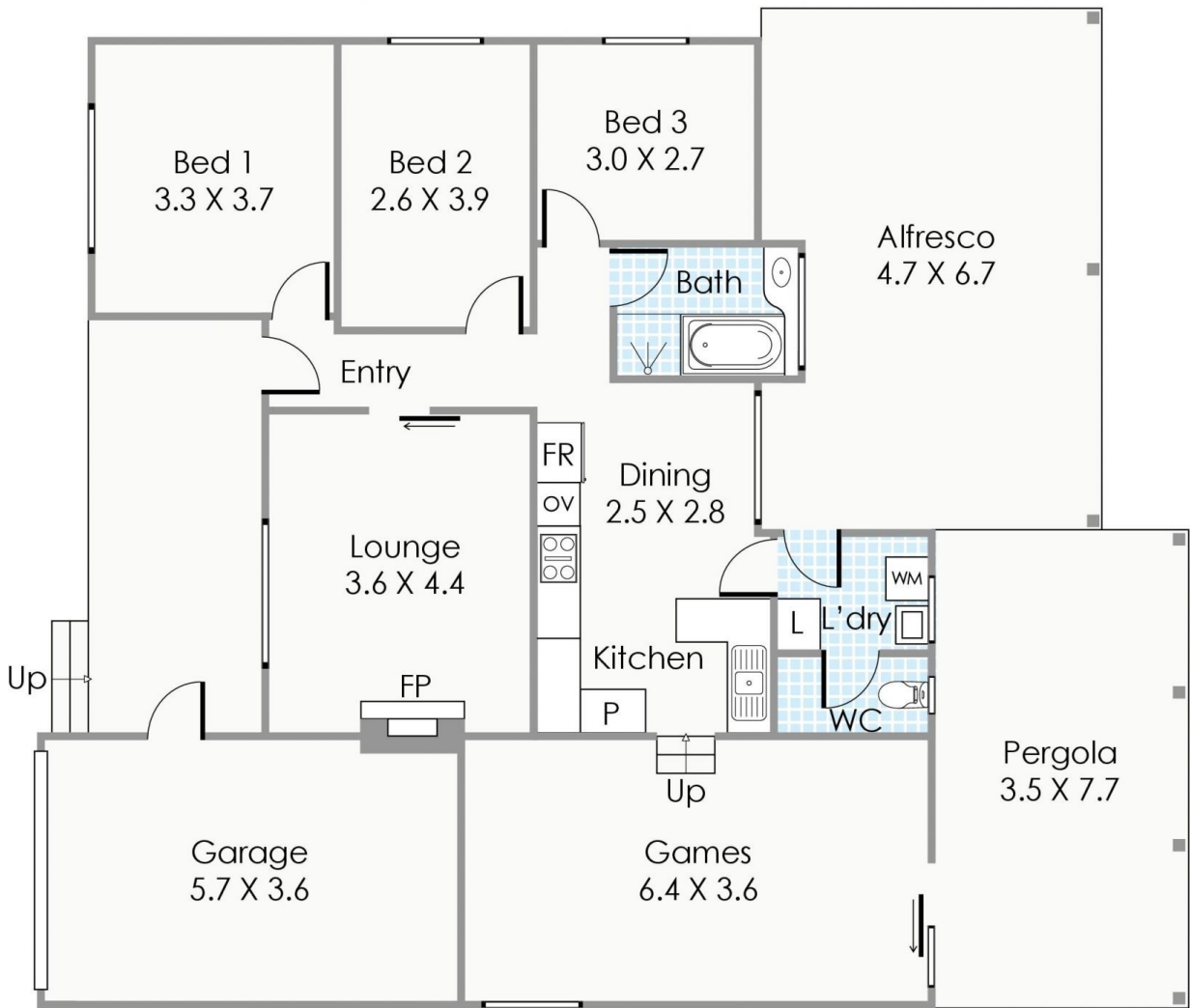

Approximate Areas

Residence:	104m ²
Garage:	21m ²
Pergola:	27m ²
Alfresco:	33m ²
Total Area:	185m ²

This floorplan is for illustration purposes only to show the layout of the property. Whilst every effort has been made to ensure the accuracy of this floor plan, all measurements, and any other information shown are an approximate interpretation only. Measurements and total areas do not include or account for wall thickness or roof area under eaves. Crib Creative will not be held liable or responsible for any error, omission, misrepresentation or use of any information shown on the final floor plan. Not to be used for any other purpose.
www.cribcreative.com.au



127 Fisher Street, Belmont