

138 Knutsford Avenue Rivervale WA

3 1 2

"Circa 1960's" double red brick & tile character home set on a rare 703sqm corner triplex block zoned R20/40. The development options here (stca) are endless with an extra wide 32.65mt street frontage onto the primary road. Renovators are well catered for with a solid character home offering excellent bones and jarrah boards to be uncovered and polished. Astute investors/developers can land bank or plan their next development right away and reap the rewards on offer within this high growth location. Whatever your vision is, this outstanding real estate opportunity will not last so express your interest today and secure your slice of Rivervale.

KEY FEATURES INCLUDE

[For full version visit the website](https://www.lauriekelly.com.au)

Type : House
Land Size : 703 sqm
View : <https://www.lauriekelly.com.au/sale/wa/east-ern-suburbs/rivervale/residential/house/7936551>



Devon Kelly
08 9277 4200

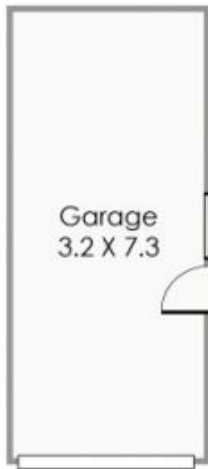

(Not Actual Location)

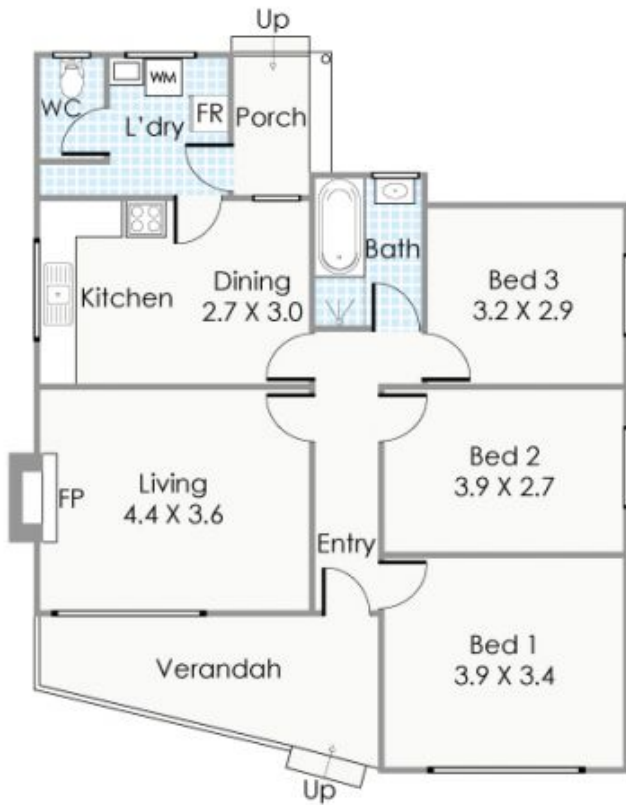

Approximate Areas

Residence:	85m ²
Garage:	23m ²
Porch:	4m ²
Verandah:	10m ²
Total Area:	122m²

This floorplan is for illustration purposes only to show the layout of the property. Whilst every effort has been made to ensure the accuracy of this floor plan, all measurements, and any other information shown are an approximate interpretation only. Measurements and total areas do not include or account for wall thickness or roof area under eaves. Ctb Creative will not be held liable or responsible for any error, omission, misrepresentation or use of any information shown on the final floor plan. Not to be used for any other purpose. www.ctbcreative.com.au



138 Knutsford Avenue, Rivervale