



4/30 Kimberley Street Belmont WA

3 2 2

Set in the private collection on Kimberley Street, you will find this end townhouse, boasting privacy, multiple living areas, large bedrooms, two courtyards all within walking distance of the Swan River and Centenary Park.

- Cleverly designed to maximize the spacious living space (157sqm), you will step inside into a light-filled entry foyer, flowing onto the formal lounge room, which opens onto one of the two courtyards, perfect for entertaining this coming summer with pergola offering shade from the heat of the Perth sun.

- The open plan kitchen, dining and living space is where you will spend most of your time, cook, create, and entertain, with sliding doors out onto the spacious

Type : Townhouse
Building Size : 157 sqm
Land Size : 269 sqm
View : <https://www.lauriekelly.com.au/sale/wa/eastern-suburbs/belmont/residential/townhouse/7936546>



Kim Findlay
08 9277 4200

[For full version visit the website](https://www.lauriekelly.com.au)

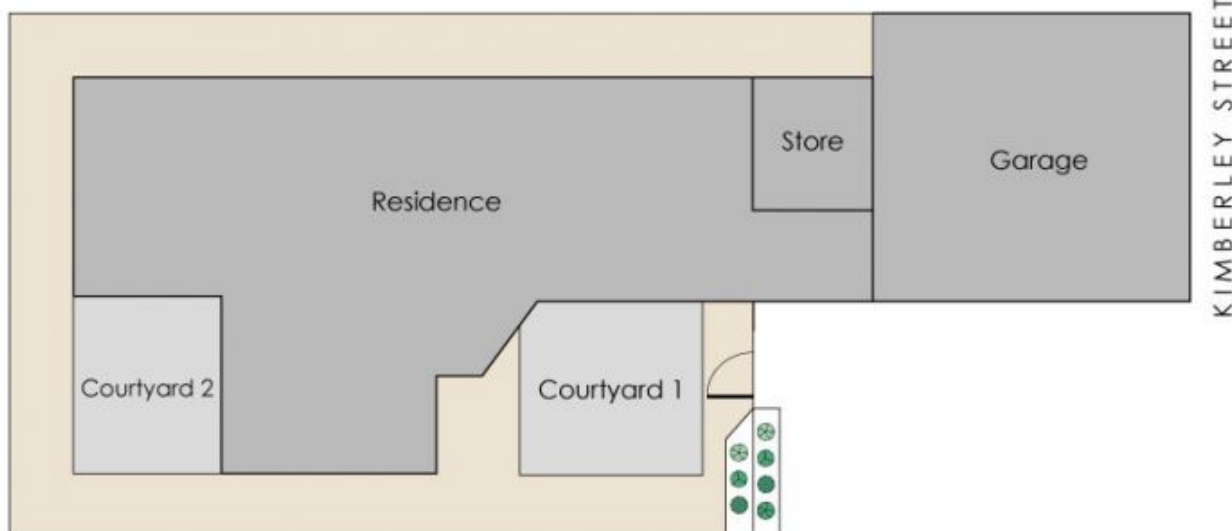
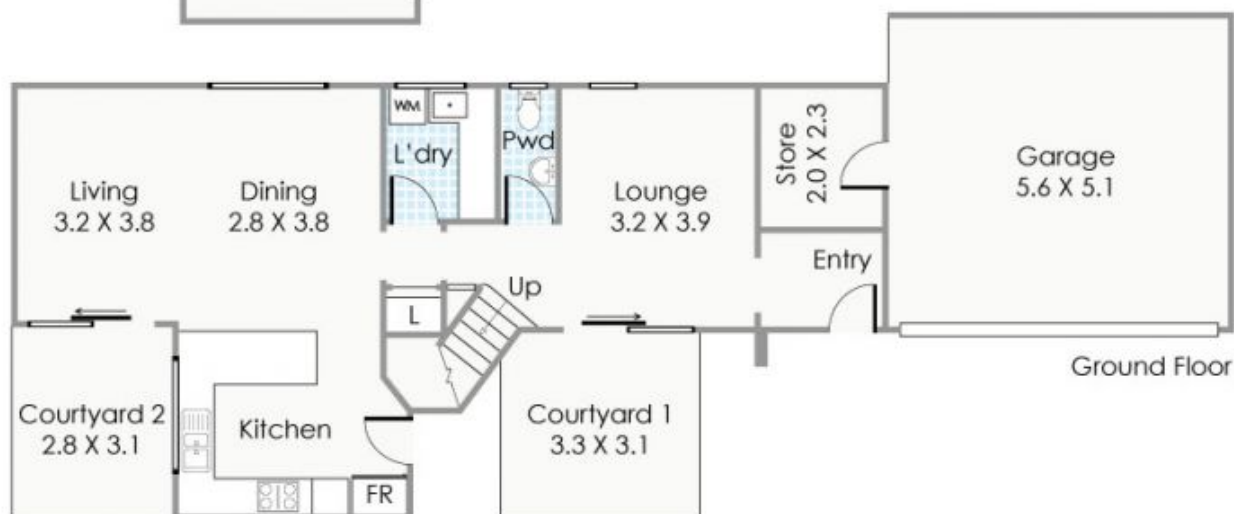
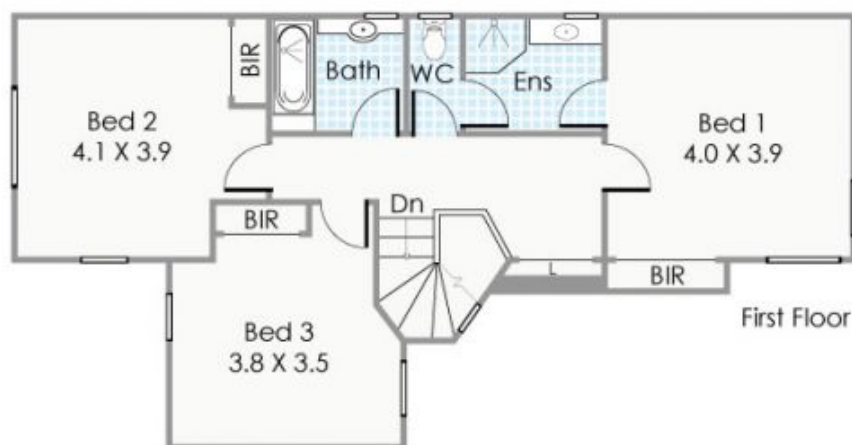

Approximate Areas

Ground Floor:	77m ²
First Floor:	80m ²
Garage:	29m ²
Store:	5m ²
Courtyard 1:	10m ²
Courtyard 2:	9m ²
Total Area:	210m²

Site Area: 269m²

This floorplan is for illustration purposes only to show the layout of the property. Whilst every effort has been made to ensure the accuracy of this floor plan, all measurements, and any other information shown are an approximate interpretation only. Measurements and total areas do not include or account for wall thickness or roof area under eaves. Ciba Creative will not be held liable or responsible for any error, omission, misrepresentation or use of any information shown on the final floor plan. Not to be used for any other purpose.
www.cibacreative.com.au



4/30 Kimberley Street, Belmont