

**78A Moreing Street Redcliffe WA**

5 2 4

**HOLLYWOOD RESIDENCE ON 569SQM GREEN TITLE BLOCK**

**(THE BIGGEST AND BEST AVAILABLE)**

Situated in sought after elevated TOP END Redcliffe location is this much loved one owner family home on private 569sqm green titled block. Constructed in 2012 and totalling 242sqm under the main roof there is plenty of space for the growing family or astute FIFO looking to rent our rooms. If you are tired of searching for your dream home and don't want to settle for second best, then you must view this property quickly before it sells this weekend.

**RED HOT FEATURES INCLUDE**

[For full version visit the website](https://www.lauriekelly.com.au)

**Type** : House  
**Building Size** : 242 sqm  
**Land Size** : 569 sqm  
**View** : <https://www.lauriekelly.com.au/sale/wa/eastern-suburbs/redcliffe/residential/house/7936539>



**Devon Kelly**  
 08 9277 4200

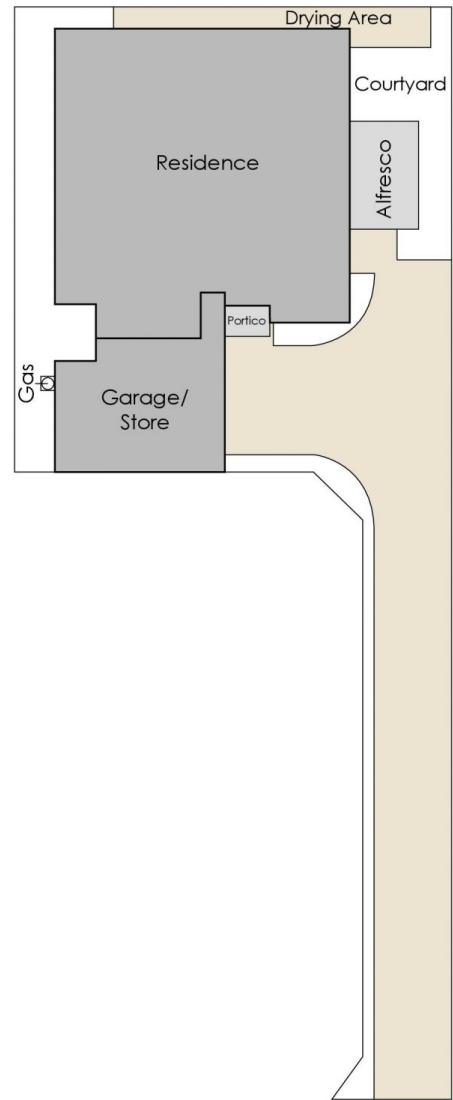

MOREING STREET

Site Area: 569m<sup>2</sup>

Approximate Areas

Residence:	177m <sup>2</sup>
Garage/Store:	47m <sup>2</sup>
Alfresco:	15m <sup>2</sup>
Portico:	3m <sup>2</sup>
<b>Total Area:</b>	<b>242m<sup>2</sup></b>

This floorplan is for illustration purposes only to show the layout of the property. Whilst every effort has been made to ensure the accuracy of this floor plan, all measurements, and any other information shown are an approximate interpretation only. Measurements and total areas do not include or account for wall thickness or roof area under eaves. Crib Creative will not be held liable or responsible for any error, omission, misrepresentation or use of any information shown on the final floor plan. Not to be used for any other purpose.  
www.cribcreative.com.au



**78A Moreing Street, Redcliffe**

