



37 Pearl Road Cloverdale WA

4 1 2

(FIRST HOME SPECIAL OR INVESTORS DREAM)

Set in one of Cloverdale's premier tree lined streets, this unique Skyline home is poised to sell very quickly. Painstakingly renovated throughout this ultra-funky residence is great for the first home buyers or investors. Boasting 160sqm of internal living space it's just perfect for the growing family or a FIFO buyer looking to rent rooms out. Don't hesitate on this one with the market on the move, value for money is assured here.

Building Size : 160 sqm
Land Size : 431 sqm
View : <https://www.lauriekelly.com.au/sale/wa/southern-suburbs/cloverdale/residential/house/7936535>

RED HOT PROPERTY FEATURES

- ? Huge 160sqm of actual living space plus double parking.
- ? Street frontage 431sqm strata survey block with no fees.
- ? Front pathway leads to timber deck and front door entry.
- ? Polished jarrah boards plus a neutral décor sets the



Devon Kelly
08 9277 4200

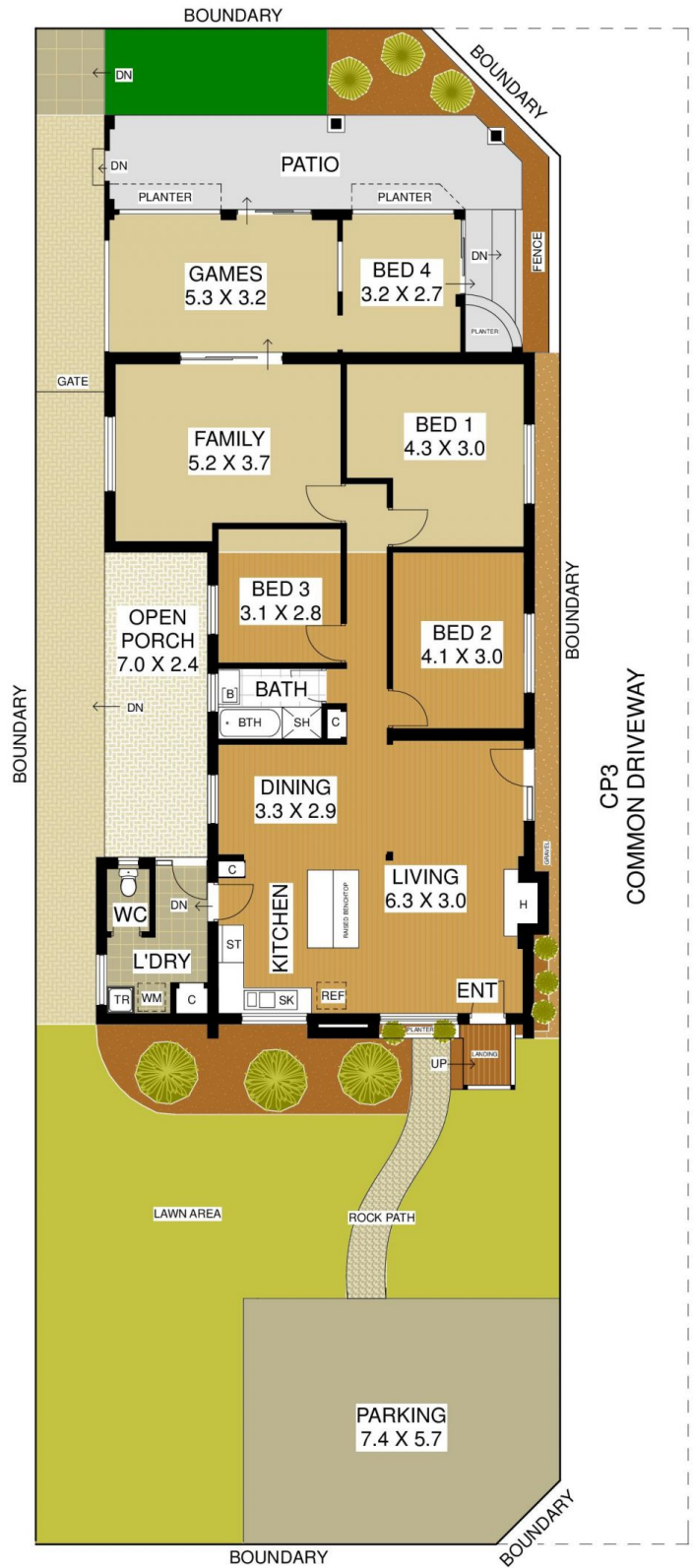

HOUSE - 160m²
 PATIO - 25m²
TOTAL - 185m²

PARKING - 42m²
 DRIVEWAY - 112m²
BLOCK - 431m²

37 Pearl Road, Cloverdale



PLAN IS APPROXIMATE AND REPRESENTATIONAL ONLY

WWW.TATEFLOORPLANS.COM.AU



HOUSE - 160m²
 PATIO - 25m²
TOTAL - 185m²

PARKING - 42m²
 DRIVEWAY - 112m²
BLOCK - 431m²

37 Pearl Road, Cloverdale



PLAN IS APPROXIMATE AND REPRESENTATIONAL ONLY

WWW.TATEFLOORPLANS.COM.AU