



2/181 Epsom Avenue Redcliffe WA

3 2 6

(VIEWING STRICTLY BY APPOINTMENT ONLY)

Seeing is believing when you view this tastefully renovated home boasting off the chart WOW factor throughout. The perfect first home for a FIFO worker to enjoy their R & R or busy city slicker who likes the finer things and loves to entertain family & friends. Privately positioned this unique abode has been transformed into a rarely found oasis centrally located for ease of convenience. My owner's instructions are crystal clear, he wants this property SOLD today, so if you like what you see make an offer!

KEY FEATURES INCLUDE

* Modern 2003 built federation style home.

[For full version visit the website](https://www.lauriekelly.com.au)

Type : House
Building Size : 187 sqm
Land Size : 356 sqm
View : <https://www.lauriekelly.com.au/sale/wa/eastern-suburbs/redcliffe/residential/house/7936492>



Devon Kelly
08 9277 4200



Daniel Kelly
08 9277 4200

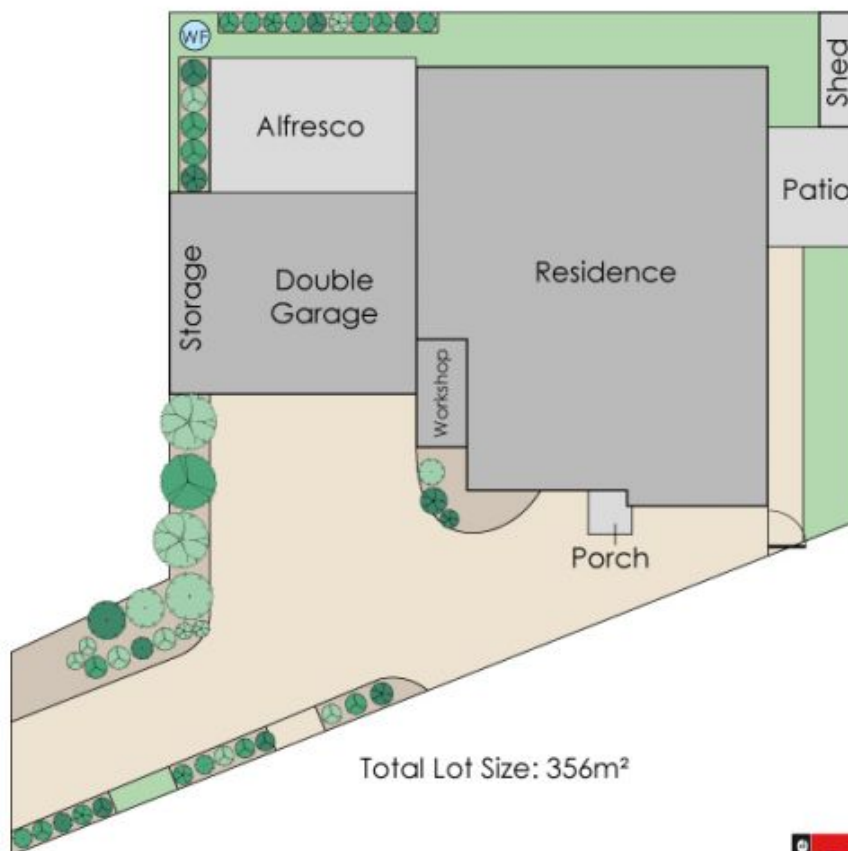
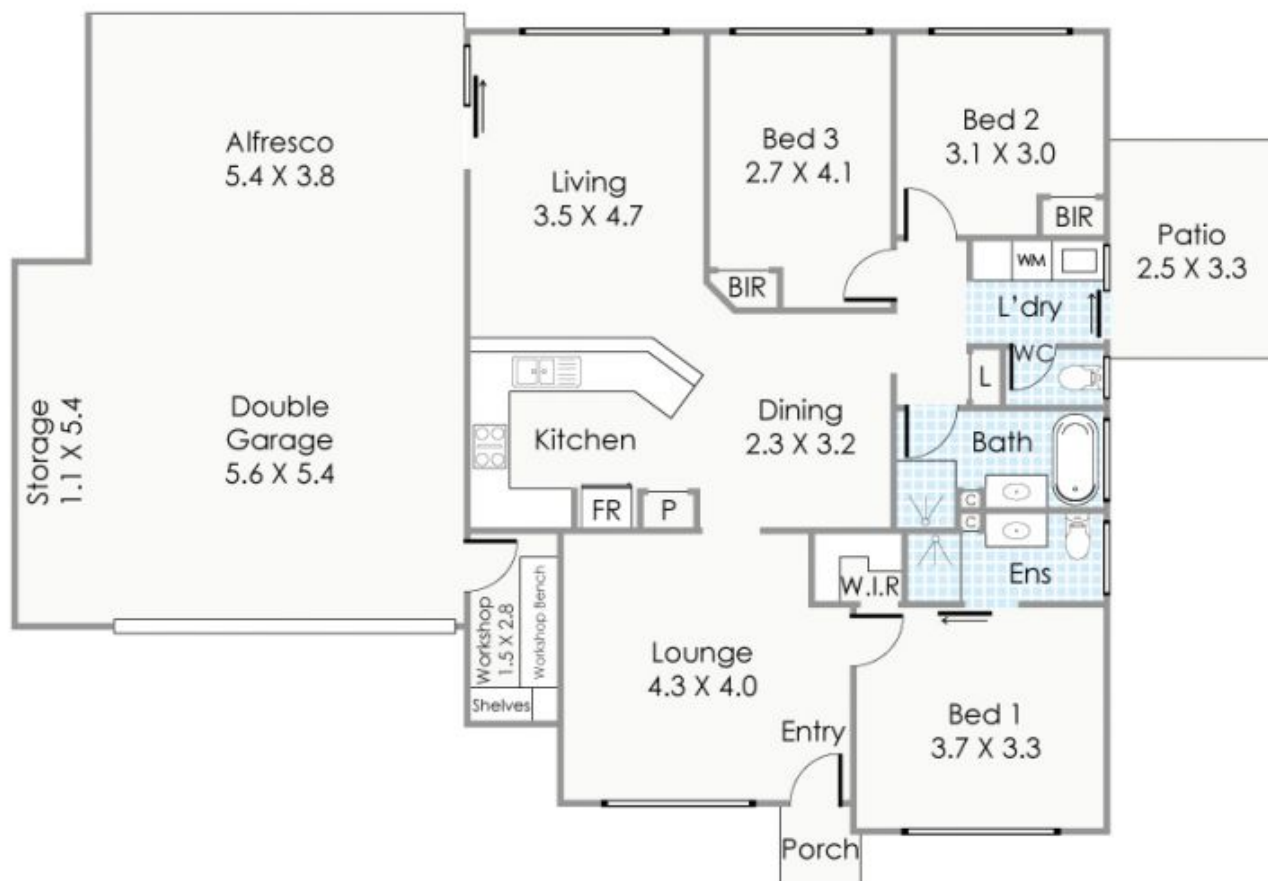

Approximate Areas

Residence:	117m ²
Double Garage:	30m ²
Workshop:	4m ²
Porch:	1m ²
Alfresco:	21m ²
Storage:	6m ²
Patio:	8m ²
Total Area:	187m²

Total Lot Size: 356m²

This floorplan is for illustration purposes only to show the layout of the property. Whilst every effort has been made to ensure the accuracy of this floor plan, all measurements, and any other information shown are an approximate interpretation only. Measurements and total areas do not include or account for wall thickness or roof area under eaves. Ciba Creative will not be held liable or responsible for any error, omission, misrepresentation or use of any information shown on the final floor plan, not to be used for any other purpose.
www.cibacreative.com.au



2/181 Epsom Avenue, Redcliffe