

**11c Harriet Place Cloverdale WA**

3 2 2

Modern style 2003 built single level home/villa in quiet group of four close to shopping and schools. Perfect for the first homebuyer, astute investor, FIFO worker or retiree wanting a low maintenance lifestyle. Freshly presented with vacant possession available this unique property is well worth your consideration.

**Type** : Villa  
**Building Size** : 137 sqm  
**Land Size** : 184 sqm  
**View** : <https://www.lauriekelly.com.au/sale/wa/southern-suburbs/cloverdale/residential/villa/7929219>

**KEY FEATURES INCLUDE**

- ? Modern 2003 built double brick & tile construction.
- ? Approx. 137sqm internally with spacious courtyard.
- ? Front entry area leading into tiled entrance hallway.
- ? Three double size bed all with BIRS main with WIRS.
- ? Two bathrooms with ensuite off the main bedroom.
- ? Open plan family/dine/kitchen overlooking courtyard.

[For full version visit the website](https://www.lauriekelly.com.au)



**Devon Kelly**  
08 9277 4200



**Daniel Kelly**  
08 9277 4200

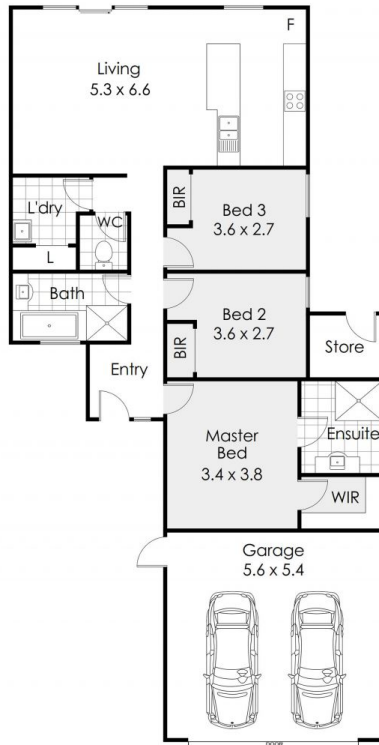

GROUND FLOOR

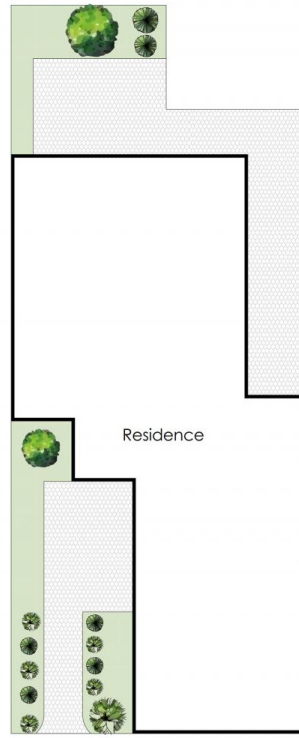

SITE PLAN



## 11c Harriet Place, Cloverdale

This floor plan is not to scale.  
 Dimensions are approximate and therefore should only be used for illustrative purposes.

-  184m<sup>2</sup>
-  3 Bed
-  2 Bath
-  2 Car