



**285 Daly Street Belmont WA**

2 1 3

First home buyers, FIFO workers and astute investors be very quick for this totally unique street frontage home/villa. Boasting an easy functional layout tastefully refurbished with fresh paint and timber plank flooring throughout. There is plenty of parking with auto lock up tandem garage plus gated front parking for your camper or boat. Centrally located close to shopping, transport, schools, parklands plus airport only 5 mins drive away. My owner wants to do a deal today on this little ripper so be quick to avoid disappointment.

**Type** : Villa  
**Building Size** : 88 sqm  
**Land Size** : 298 sqm  
**View** : <https://www.lauriekelly.com.au/sale/wa/eastern-suburbs/belmont/residential/villa/7929217>

**KEY FEATURES INCLUDE**

- ? Double brick & tile construction with own street frontage.
- ? Covered front entry area with auto tandem lock up

[For full version visit the website](https://www.lauriekelly.com.au)



**Devon Kelly**  
 08 9277 4200



**Daniel Kelly**  
 08 9277 4200

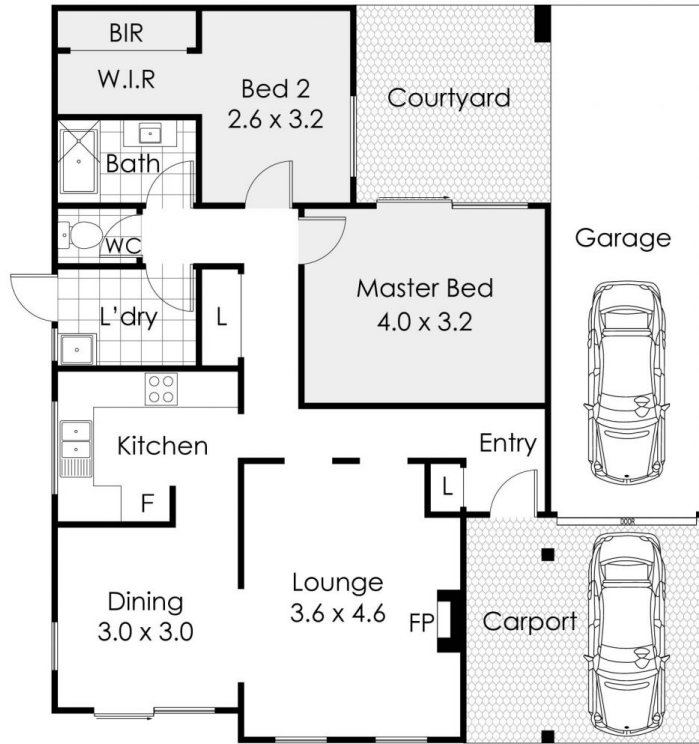

285 Daly Street, Belmont

This floor plan is not to scale.  
 Dimensions are approximate and therefore should only be used for illustrative purposes.

-  132 m<sup>2</sup>
-  2 Bed
-  1 Bath
-  2 Car