



262c Acton Avenue Kewdale WA

3 1 4

Simply move into this tastefully renovated street frontage home in super handy central location only a short stroll away from the Belmont Forum. Situated on a prime 560sqm block with a wide 19.8mt frontage and zoned R20/40 with future development potential available you can't go wrong. The current owner has transformed this much-loved family home into the perfect entertainer with fantastic outdoor and indoor spaces. If you have been looking for a combination of lifestyle, location, amenities, and development potential in a well-priced property well this is it. My owner is keen to do a deal, so come forward with your cheque book in hand and let's talk today!

Type : House
Land Size : 560 sqm
View : <https://www.lauriekelly.com.au/sale/wa/southern-suburbs/kewdale/residential/house/7929209>



Devon Kelly
 08 9277 4200

SIZZLING HOT FEATURES INCLUDE

[For full version visit the website](#)

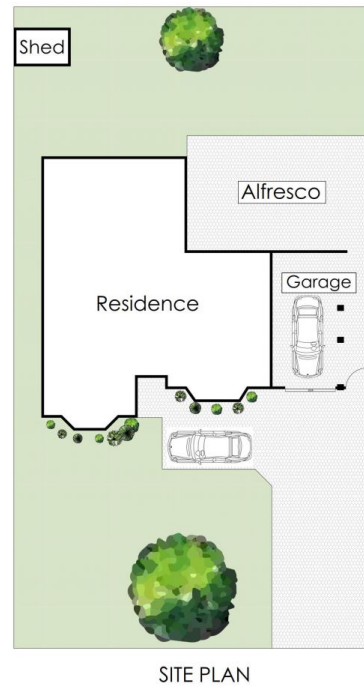
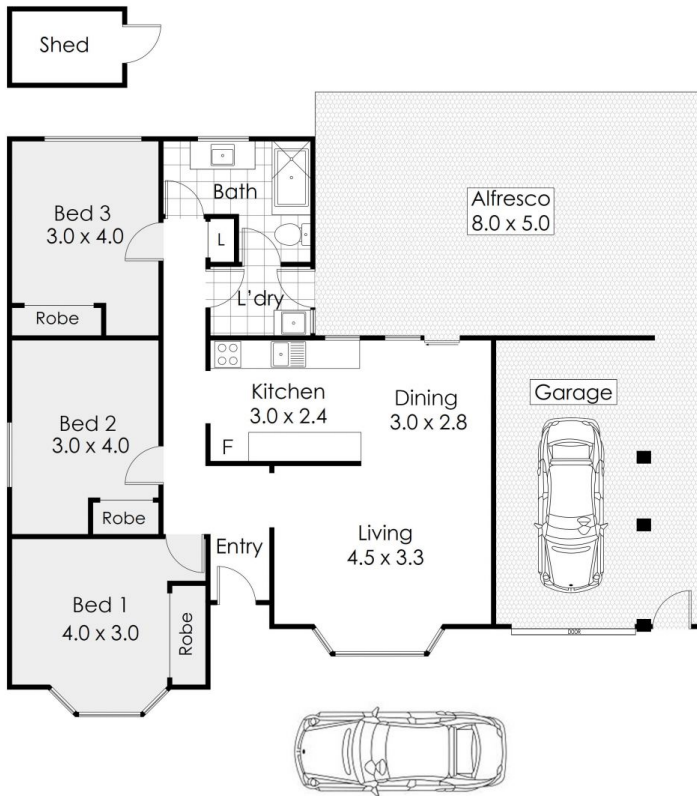

262c Acton Avenue, Kewdale

This floor plan is not to scale.
 Dimensions are approximate and therefore should only be used for illustrative purposes.

	560m ²
	3 Bed
	1 Bath
	2 Car