



8/6 Dane Street East Victoria Park WA

1 1 1

A prized location - smack bang in the middle of Perth's most popular cafe strips, welcome to apartment 8 set on the very top floor at 6 Dane Street, East Victoria Park. A great place to live and an even better place to invest!

This top floor - penthouse-esque type apartment boasts stunning views out to the hills and beyond. Combining 56sqm of total living space which includes a large private balcony.

Features include:

- ? Secure gated pedestrian and gated access
- ? Allocated (1) parking bay (15sqm)
- ? Top floor apartment

[For full version visit the website](https://www.lauriekelly.com.au)

Type : Block of Units
Land Size : 56 sqm
View : <https://www.lauriekelly.com.au/sale/wa/southern-suburbs/east-victoria-park/residential/block-of-units/7564084>



Kim Findlay
08 9277 4200

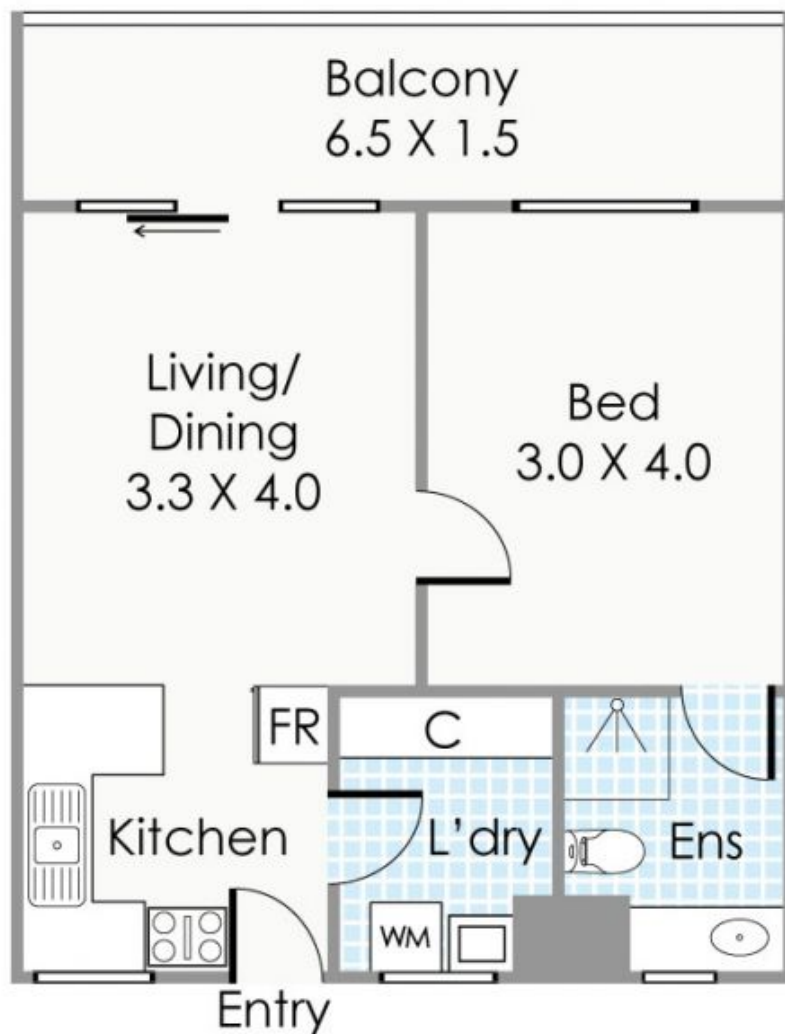

Car Bay
5.6 X 2.4
*For Exclusive Use

(Not Actual Location)

Approximate Areas

Residence:	46m ²
Balcony:	10m ²
Car Bay:	15m ²
Total Area:	71m ²

This floorplan is for illustration purposes only to show the layout of the property. Whilst every effort has been made to ensure the accuracy of this floor plan, all measurements, and any other information shown are an approximate interpretation only. Measurements and total areas do not include or account for wall thickness or roof area under eaves. Cibo Creative will not be held liable or responsible for any error, omission, misrepresentation or use of any information shown on the final floor plan. Not to be used for any other purpose.
www.cibocreative.com.au



8/6 Dane Street, East Victoria Park