



280b Belgravia Street Cloverdale WA

3 1 4

HOME OPEN CANCELLED

Centrally located walking distance to Belmont Forum, schooling & parklands is this well-maintained home offering privacy and security. With hard to find off street gated parking for four vehicles, boat or caravan you will be amazed at the space available. The solid red double brick and tile custom designed construction boasts a practical layout with two dedicated living zones with plenty of natural light. The rear yard, patio and surrounding garden beds are an oasis of tranquility perfect for the relaxing homebody or vibrant entertainer. Be assured that this hot Perth real estate market will sell this outstanding property very quickly so act fast to make it yours.

Type : House
Land Size : 396 sqm
View : <https://www.lauriekelly.com.au/sale/wa/southern-suburbs/cloverdale/residential/house/7556087>



Devon Kelly
08 9277 4200



Daniel Kelly
08 9277 4200

[For full version visit the website](https://www.lauriekelly.com.au)

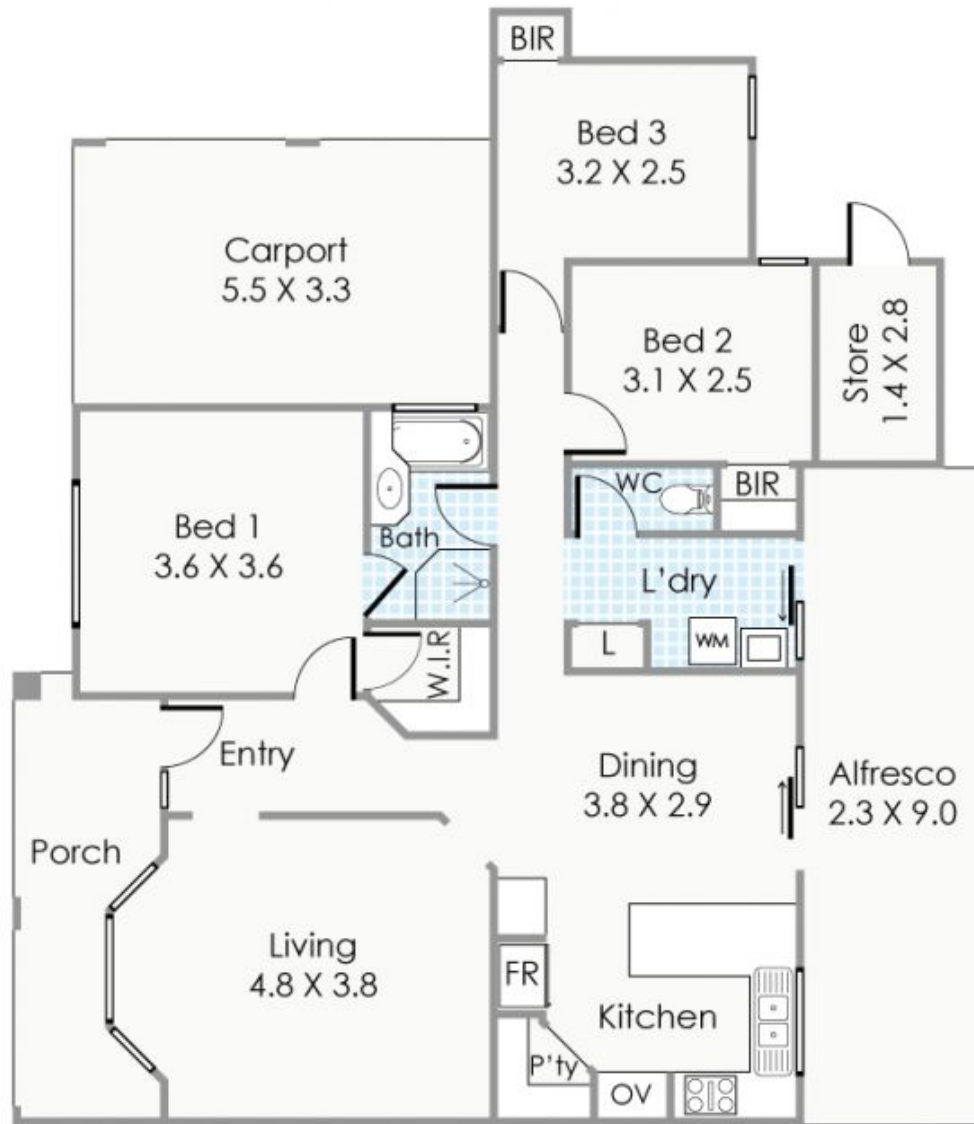

BELGRAVIA STREET

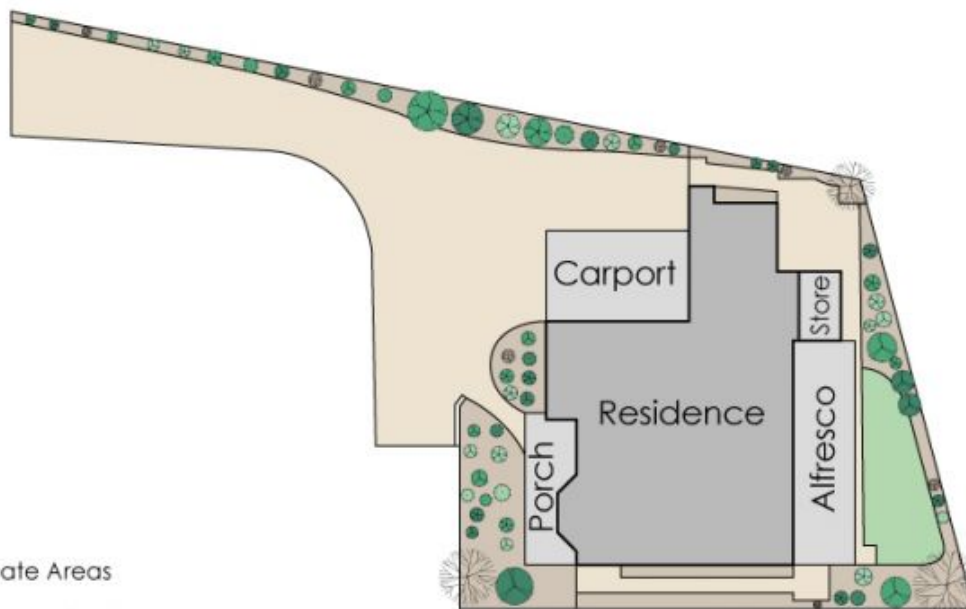

Total Strata Lot: 396m²

Approximate Areas

Residence:	96m ²
Store:	4m ²
Alfresco:	21m ²
Carport:	18m ²
Porch:	9m ²

Total Area: 148m²

This floorplan is for illustration purposes only to show the layout of the property. Whilst every effort has been made to ensure the accuracy of this floor plan, all measurements and total areas do not include or account for wall thickness or roof area under eaves. Ctb Creative will not be held liable or responsible for any error, omission, misrepresentation or use of any information shown on the first floor plan. Not to be used for any other purpose. www.ctbcreative.com.au



280B Belgravia Street, Cloverdale