



8 Whitchurch Road Redcliffe WA

3 2 1

Built in 1998 this oversized 3-bedroom x 2-bathroom family sized home sits in popular Ascot Gardens Estate and is priced to sell!

Features include:

- ? Formal lounge room fully tiled
- ? Open study area but could easily be converted to a 4th bedroom
- ? Large open plan kitchen/dining/family room opening onto paved patio area
- ? Games room off main living area
- ? Central kitchen with heaps of bench space
- ? Master bedroom with parents retreat, walk in robe and ensuite situated at the front of the home
- ? Bedrooms 2 & 3 all with BIR"s at the opposite end of the

Type : House
Land Size : 420 sqm
View : <https://www.lauriekelly.com.au/sale/wa/eastern-suburbs/redcliffe/residential/house/7494881>



Kim Findlay
08 9277 4200

[For full version visit the website](https://www.lauriekelly.com.au)

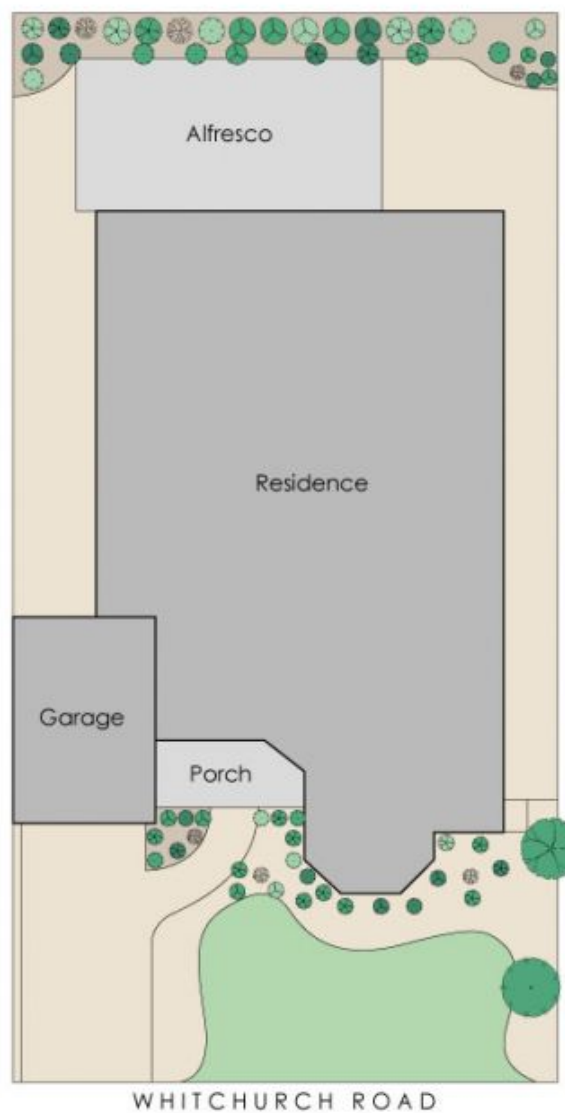
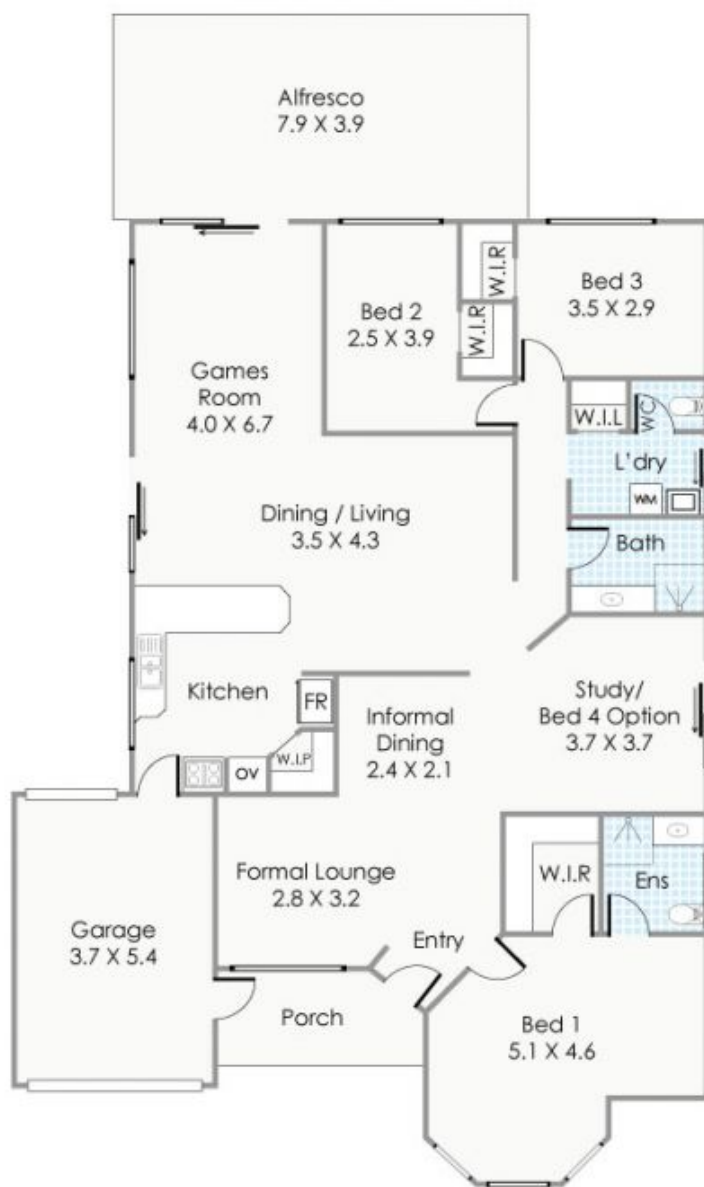

Approximate Areas

Residence:	166m ²
Garage:	20m ²
Alfresco:	31m ²
Porch:	6m ²
Total Area:	223m²

This floorplan is for illustration purposes only to show the layout of the property. Whilst every effort has been made to ensure the accuracy of this floor plan, all measurements, and any other information shown are an approximate interpretation only. Measurements and total areas do not include or account for wall thickness or roof area under eaves. Cibo Creative will not be held liable or responsible for any error, omission, misrepresentation or use of any information shown on the final floor plan. Not to be used for any other purpose.
www.cibocreative.com.au



8 Whitchurch Road, Redcliffe