



**68 Hotham Avenue Boddington WA**

6 🏠 5 🚗 6 🚗

Rare opportunity to secure three properties at Perth entry level pricing set on a vast 1391sqm currently split into two green titles of blocks of land. Could it be the ultimate set-up for a growing family or be the springboard to your financial future as an investment! My investor is clear - "get em sold"!

**Type** : House  
**Land Size** : 1391 sqm  
**View** : <https://www.lauriekelly.com.au/sale/wa/east/boddington/residential/house/7462870>

Nestled between the rolling hills of the forest and the banks Boddington's Hotham River Foreshore, this charming abode gives you easy access to the famous annual Rodeo and a short drive to the famous Gold Mine. When you are not exploring your own back garden, you can explore the town or head out to Hotham River trails and take in its natural beauty.



**Kim Findlay**  
 08 9277 4200

[For full version visit the website](https://www.lauriekelly.com.au)

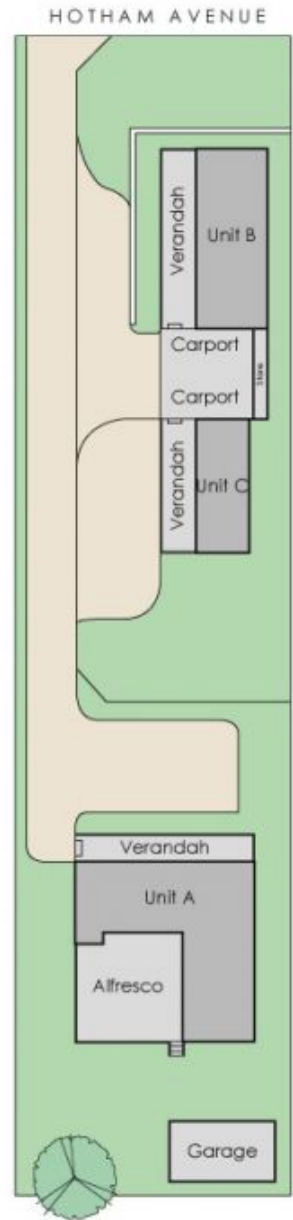
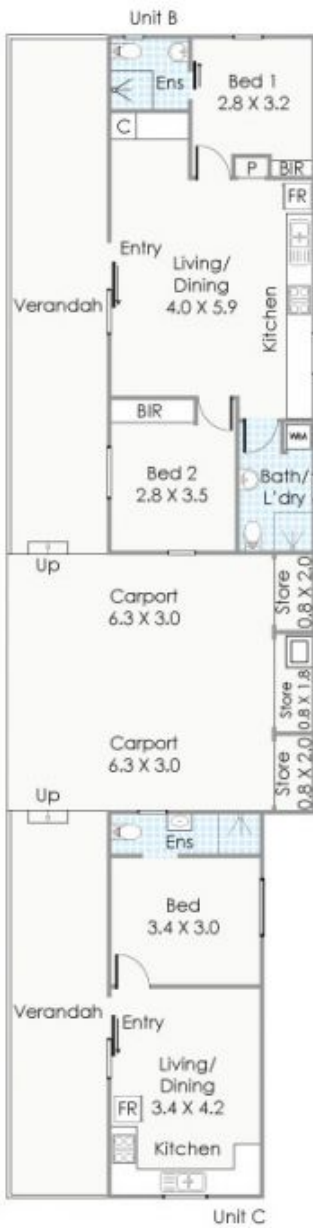

**Approximate Areas**

<b>UNIT A</b>	
Residence:	88m <sup>2</sup>
Garage:	27m <sup>2</sup>
Alfresco:	50m <sup>2</sup>
Verandah:	20m <sup>2</sup>
<b>UNIT B</b>	
Residence:	55m <sup>2</sup>
Verandah:	28m <sup>2</sup>
Carport:	19m <sup>2</sup>
<b>UNIT C</b>	
Residence:	30m <sup>2</sup>
Verandah:	20m <sup>2</sup>
Carport:	19m <sup>2</sup>
<b>Total Area:</b>	<b>356m<sup>2</sup></b>

This floor plan is for illustration purposes only to show the layout of the property. Whilst every effort has been made to ensure the accuracy of this floor plan, all measurements, and any other information shown are an approximate interpretation only. Measurements and total areas do not include or account for wall thickness or roof area under eaves. Ciba Creative will not be held liable or responsible for any error, omission, misrepresentation or use of any information shown on the final floor plan. Not to be used for any other purpose.  
www.cibacreative.com.au



**68 Hotham Avenue, Boddington**

